



# MR16 10 000 Hour Life Cover Glass

EYE's MR16 10 000 hour lamps with a special dichroic coating provide extra long life while delivering consistent light and brightness. The durable dichroic coating protects heat sensitive objects. Its accurate optical design delivers light exactly where it is directed.

Consistency in colour and brightness means the lamp bathes displays in uniform light for maximum effect. With these lamps there are lower maintenance costs and fewer disruptions in high traffic and hard to reach areas.

## Features

- Super long life
- Long lasting dichroic coating
- Consistent light and brightness

## Applications

- Display cases
- Retail stores
- Restaurants
- Track and recessed lighting
- Offices
- Landscapes
- Hard to reach areas
- Commercial

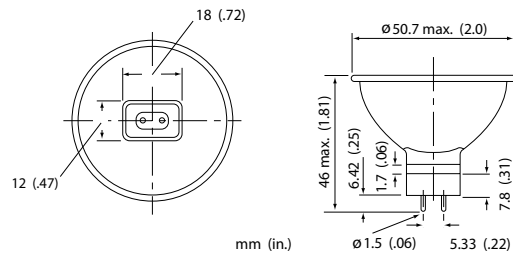

Order code	Description	ANSI code	Watts (W)	Base	Volts (V)	Colour temp. (K)	Beam angle (°)	CBCP*	Average life (hrs)	MOL** (in.) (mm)	Pack/Case Qty
59819	20MR16/CG/NFL/10M BBF EYE	BBF	20	GU5.3	12	2 950	23	880	10 000	1.81 46	12/120
58109	20MR16/CG/FL/10M BAB EYE	BAB	20	GU5.3	12	2 950	36	500	10 000	1.81 46	12/120
59801	20MR16/CG/SP/10M ESX EYE	ESX	20	GU5.3	12	2 950	9	4 000	10 000	1.81 46	12/120
30461	35MR16/CG/FL/10M FMW EYE	FMW	35	GU5.3	12	3 050	36	1 100	10 000	1.81 46	12/120
30457	50MR16/CG/SP/10M EXT EYE	EXT	50	GU5.3	12	3 050	12	9 500	10 000	1.81 46	12/120
30459	50MR16/CG/NFL/10M EXZ EYE	EXZ	50	GU5.3	12	3 050	25	3 100	10 000	1.81 46	12/120
30460	50MR16/CG/FL/10M EXN EYE	EXN	50	GU5.3	12	3 050	36	1 650	10 000	1.81 46	12/120

## MR16 10 000 hours

\* Center Beam Candle Power  
\*\* Conversions may vary slightly



# MR16 10 000 Hour Life Cover Glass



Order code	Description	ANSI code	Watts (W)	Base	Volts (V)	Colour temp. (K)	Beam angle (°)	CBCP*	Average life (hrs)	MOL** (in.) (mm)	Pack/Case Qty
<b>MR16 10 000 hours UV Cut</b>											
59820	20MR16/CG/UVC/SP/10M ESX EYE	ESX	20	GU5.3	12	2 950	9	4 000	10 000	1.81 46	12/120
59821	20MR16/CG/UVC/NFL/10M BBF EYE	BBF	20	GU5.3	12	2 950	23	880	10 000	1.81 46	12/120
59822	20MR16/CG/UVC/FL/10M BAB EYE	BAB	20	GU5.3	12	2 950	38	500	10 000	1.81 46	12/120
59823	35MR16/CG/UVC/SP/10M FRB EYE	FRB	35	GU5.3	12	3 050	12	7 400	10 000	1.81 46	12/120
59824	35MR16/CG/UVC/NFL/10M FRA EYE	FRA	35	GU5.3	12	3 050	22	2 200	10 000	1.81 46	12/120
59825	35MR16/CG/UVC/FL/10M FMW EYE	FMW	35	GU5.3	12	3 050	36	1 100	10 000	1.81 46	12/120
59826	50MR16/CG/UVC/SP/10M EXT EYE	EXT	50	GU5.3	12	3 050	12	9 500	10 000	1.81 46	12/120
59827	50MR16/CG/UVC/NFL/10M EXZ EYE	EXZ	50	GU5.3	12	3 050	25	3 100	10 000	1.81 46	12/120
<b>MR16 10 000 hours - UV Cut, High Colour Temperature (3 450 K)</b>											
59834	50MR16/CG/UVC/FL/10M/3450K EXN EYE	EXN	50	GU5.3	12	3 450	36	1 300	10 000	1.81 46	12/120

\* Center Beam Candle Power  
\*\* Conversions may vary slightly



# MR16 10 000 Hour Life Cover Glass

## Photometrics

### MR16 10 000 hours life

#### 20 watts

Beam angle: 9°

Ø (in.)	H(ft)	(fc)
6 7/16	3' 3 3/8"	372
12 7/32	6' 6 1/4"	93
18 1/2	9' 10 1/8"	41

59801

Beam angle: 23°

Ø (in.)	H(ft)	(fc)
16 1/2	3' 3 3/8"	82
32 1/2	6' 6 1/4"	20
48 7/16	9' 10 1/8"	9

59819

Beam angle: 36°

Ø (in.)	H(ft)	(fc)
25 3/16	3' 3 3/8"	45
50 25/32	6' 6 1/4"	11
76 3/8	9' 10 1/8"	5

58109

#### 35 watts

Beam angle: 36°

Ø (in.)	H(ft)	(fc)
25 3/16	3' 3 3/8"	99
50 25/32	6' 6 1/4"	24
76 3/8	9' 10 1/8"	11

30461

#### 50 watts

Beam angle: 12°

Ø (in.)	H(ft)	(fc)
8 7/32	3' 3 3/8"	883
16 3/16	6' 6 1/4"	223
24 13/16	9' 10 1/8"	98

30457

Beam angle: 25°

Ø (in.)	H(ft)	(fc)
17 3/16	3' 3 3/8"	288
34 23/32	6' 6 1/4"	73
51 31/32	9' 10 1/8"	32

30459

Beam angle: 36°

Ø (in.)	H(ft)	(fc)
25 3/16	3' 3 3/8"	153
50 25/32	6' 6 1/4"	38
76 3/8	9' 10 1/8"	17

30460

### MR16 10 000 hours - UV Cut, High Colour Temperature (3 450 K)

#### 50 watts

Beam angle: 36°

Ø (in.)	H(ft)	(fc)
25 13/32	3' 3 3/8"	121
51 3/16	6' 6 1/4"	30
76 25/32	9' 10 1/8"	13

59834

### MR16 10 000 hours UV Cut

#### 20 watts

Beam angle: 9°

Ø (in.)	H(ft)	(fc)
8 1/2	3' 3 3/8"	372
16 3/16	6' 6 1/4"	93
24 13/16	9' 10 1/8"	41

59820

Beam angle: 23°

Ø (in.)	H(ft)	(fc)
16 1/2	3' 3 3/8"	82
32 1/2	6' 6 1/4"	20
48 7/16	9' 10 1/8"	9

59821

Beam angle: 38°

Ø (in.)	H(ft)	(fc)
25 31/32	3' 3 3/8"	46
52 1/2	6' 6 1/4"	12
78 11/32	9' 10 1/8"	5

59822

#### 35 watts

Beam angle: 12°

Ø (in.)	H(ft)	(fc)
8 7/32	3' 3 3/8"	687
16 3/16	6' 6 1/4"	172
24 13/16	9' 10 1/8"	76

59823

Beam angle: 22°

Ø (in.)	H(ft)	(fc)
15 11/32	3' 3 3/8"	204
30 23/32	6' 6 1/4"	51
46 1/16	9' 10 1/8"	22

59824

Beam angle: 36°

Ø (in.)	H(ft)	(fc)
25 3/16	3' 3 3/8"	99
50 25/32	6' 6 1/4"	24
76 3/8	9' 10 1/8"	11

59825

#### 50 watts

Beam angle: 12°

Ø (in.)	H(ft)	(fc)
8 7/32	3' 3 3/8"	883
16 3/16	6' 6 1/4"	223
24 13/16	9' 10 1/8"	96

59826

Beam angle: 25°

Ø (in.)	H(ft)	(fc)
17 3/16	3' 3 3/8"	288
34 23/32	6' 6 1/4"	72
51 31/32	9' 10 1/8"	32

59827