

2,2 Nm ± 0,2 / 19.5 lb-in ± 1.8

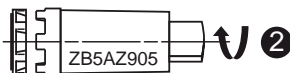

Maxi 0,8 Nm / 7.5 lb-in



Field Wiring : 22 – 16 AWG

**⚠ ⚠ DANGER**

**HAZARD OF ARC FLASH OR ELECTRIC SHOCK**

- Hole diameter and tightening torques must comply with the specifications provided in this document.
- The accessory ZB5AZ905 must be used to tighten the nut.
- Do not remove the cap with voltage present.

**Failure to follow these instructions will result in death or serious injury.**

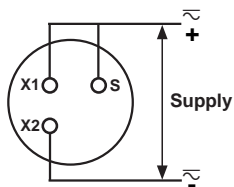

Intermittent XB5KS●

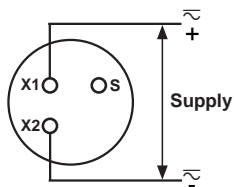

Continuous XB5KS●

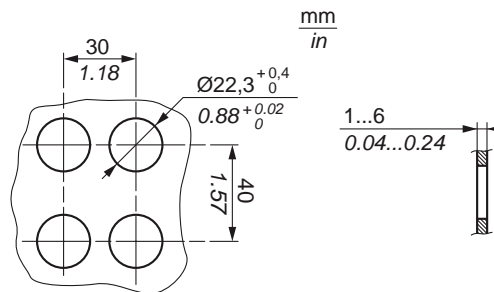

For use on flat surface of a type 4, 4X, 12 and 13 enclosure.