

# Product End-of-Life Instructions

## ALTIVAR PROCESS / MACHINES

### Product Range

Altivar Process – Ranges: 30 to 45 kW – 3PH – 200/240 V – IP21 / 55 to 90 kW – 3PH – 400/480V – IP21

### Marketing Model

ATV630D90N4, ATV630D55N4, ATV650D75N4, ATV630D30M3, ATV630D37M3, ATV630D45M3, ATV930D30M3, ATV930D37M3, ATV930D45M3, ATV930D55N4, ATV930D75N4, ATV930D90N4

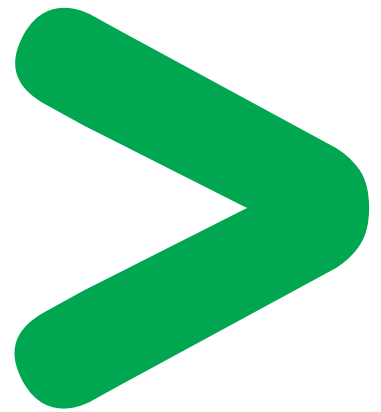

### Size in mm:

W x H x D : 293 x 930 x 330

### Weight in g:

From 27500 to 57500 for the product range.

Weight is 57500 for ATV630D90N4 including packaging and batteries (weight of the battery is 3)



## Operations recommended for the end of life treatment

There are several steps to process the products at the end of life so as to recover components, materials or energy :

Reuse ⇒ Separation for special treatment ⇒ Other Dismantling ⇒ Shredding

This product contains electrolytic capacitors which may cause electrical shock during the end of life treatment process. **BEFORE SERVICING, REMOVE ALL POWER, WAIT 15 MINUTES.**

The components of the products that optimize the recycling performances are listed, identified and located hereunder.

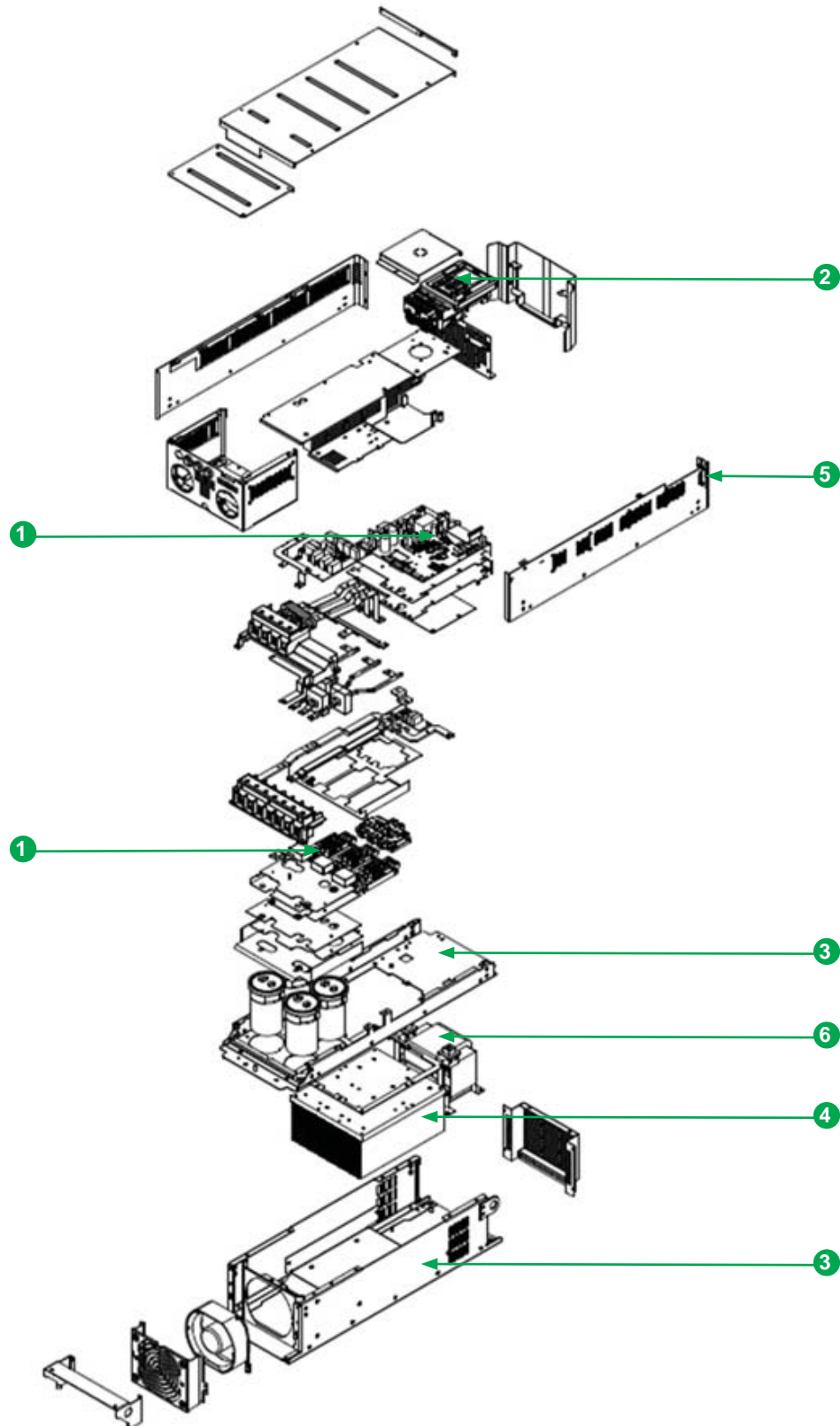

Note:



Recommendation	Number on drawing	Components	Weight (g)	Comment
Operating hazards	6	Electrolytic capacitors	123	DC Choke
Special treatment	1	Printed Circuit Board Assembly (PCBA) or power components	2357	8 PCBAs are included
	2	Manganese Dioxide Lithium Coin Battery	3	The battery is located inside the Keypad
Other dismantling	3	Plastic part	5068	PC FR, Housing, Chassis
	4	Aluminium	10104	Heatsink
	5	Steel	22564	-

**Schneider Electric Industries SAS**

35, rue Joseph Monier  
CS30323  
F - 92506 Rueil Malmaison Cedex

RCS Nanterre 954 503 439  
Capital social 896 313 776 €  
www.schneider-electric.com

The version of the Guide used to create the document: End of Life Instruction Drafting Guide of Schneider Electric version V6.

Publication : Schneider Electric