

456 Malleable Split Ring Hanger for Copper Tube – 4560050CP

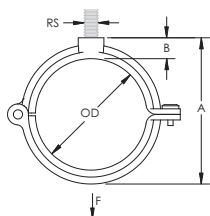

- Recommended for the suspension of stationary non-insulated copper tube lines
- Allows for piping runs close to ceiling or walls
- Conforms with Federal Specification WW-H-171 (Type 25), Manufacturers Standardization Society (MSS) SP-58 (Type 12)



Part Number	4560050CP
Material	Cast Iron
Finish	Copper Electroplated
Copper Tube Size	1/2"
Outer Diameter (OD)	5/8"
Rod Size (RS)	3/8"
A	1 1/8"
B	3/8"
Static Load (F)	180 lb
Standard Packaging Quantity	100 pc
UPC	78285636882

Bolt and rivet are carbon steel.

WARNING

Pentair products shall be installed and used only as indicated in Pentair's product instruction sheets and training materials. Instruction sheets are available at erico.pentair.com and from your Pentair customer service representative. Improper installation, misuse, misapplication or other failure to completely follow Pentair's instructions and warnings may cause product malfunction, property damage, serious bodily injury and death and/or void your warranty.

© 2018 Pentair All rights reserved

Pentair, CADDY, CADWELD, CRITEC, ERICO, ERIFLEX, ERITECH and LENTON are owned by Pentair or its global affiliates.

All other trademarks are the property of their respective owners. Pentair reserves the right to change specifications without prior notice.

