

# Accessories



- KwikWire™ system replaces jack chain or ATR to support lighting, ductwork, cable tray, etc.
- Can be quickly installed around beams - No drilling required.
- Ideal for sloped ceilings - can hang objects at up to 60° angles.
- Simple height adjustments are made by releasing locking tab, no tools required.
- Spools of wire can be cut to length in field, reducing waste and up front planning.

## KwikWire™ Clamps



UPC/Part Number	Catalog Number	For Use With Wire Rope Diameters	Box Qty.
782051 40719	<b>BKC100</b>	1/16" & 3/32"	100
782051 40723	<b>BKC200</b>	1/8" & 3/16"	50

### KwikWire™ Clamp Working Loads\*

Clamp Part No.	Wire Rope Dia.	Lbs. Safety Factor 5
BKC100	1/16"	0-75
	3/32"	25-150
BKC200	3/32"	25-150
	1/8"	25-250
	3/16"	50-640

\* Working loads shown are for hanging vertically. For suspending at 15°, 30°, 45° or 60° angles from vertical use the following percentage of the working loads from the chart:  
 15° = 96%, 30° = 86%,  
 45° = 70%, 60° = 50%

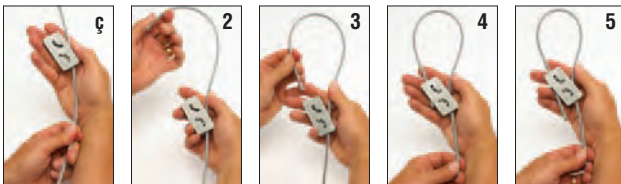

1. Pass the wire through the KwikWire™ Clamp
2. Loop wire through/around support
3. Pass wire back through KwikWire™ Clamp
4. Push wire through clamp leaving 2" to 3" tail, then apply tension on wire
5. To adjust, remove tension and pull wire slightly to disengage teeth, slide adjustment pin in direction shown by arrow to release wire.

Read safety/installation instruction sheets in packages before use.