

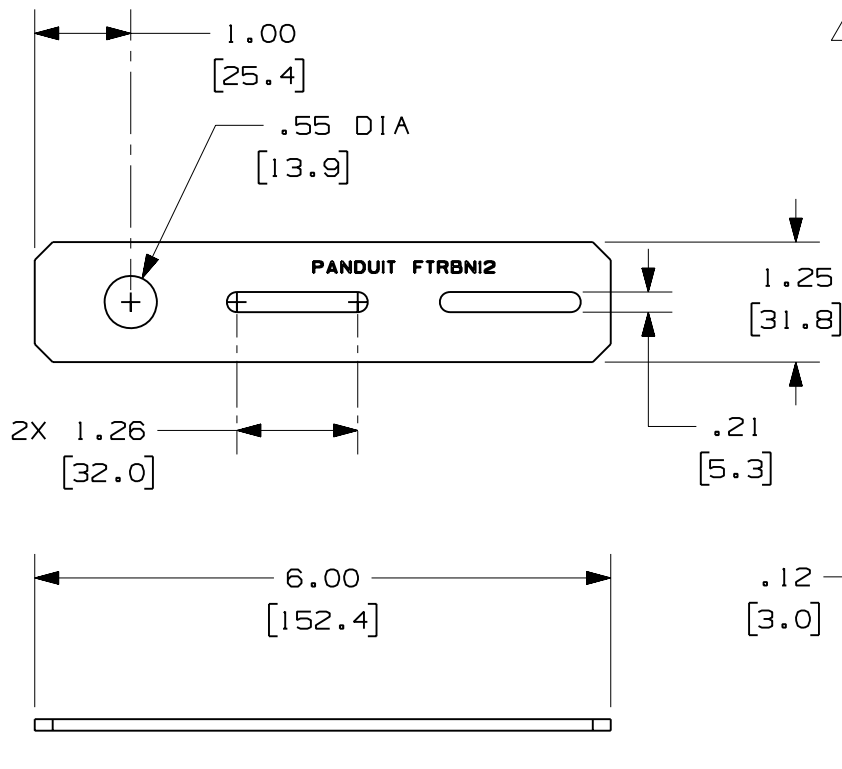

PANDUIT PART NUMBER	WEIGHT
FTRBN12 FTRBN12M	0.39 LB/EACH (176g/EACH)



NOTES:

- SEE CURRENT CATALOG FOR ADDITIONAL PART SUFFIXES TO INDICATE PACKAGE QUANTITY.
- THE FIBER-DUCT 2x2, 4x4 AND FIBERRUNNER 2x2 NEW THREADED ROD BRACKET IS USED TO SUPPORT THE FIBER-DUCT 2x2, 4x4 AND FIBERRUNNER 2x2 CABLE ROUTING SYSTEMS FROM A SECTION OF NEW 1/2" (M12) THREADED ROD.
- THE FIBER-DUCT 2x2, 4x4 AND FIBERRUNNER 2x2 NEW THREADED ROD BRACKET INCLUDES:
ONE (1) BRACKET,
TWO (2) 1/2-13 HEAVY HEX NUTS (FTRBN12 ONLY),
TWO (2) 1/2" HELICAL SPRING LOCKWASHERS,
TWO (2) M12x1.75 HEX NUTS (FTRBN12M ONLY),
TWO (2) #10-32x1/2 PAN HEAD SLOTTED MACHINE SCREWS,
TWO (2) #10-32 HEX MACHINE SCREW NUTS,
TWO (2) #10 HELICAL SPRING LOCKWASHERS.
- FINISH COLOR: YELLOW ZINC DICHROMATE (EXCEPT HARDWARE)
- DIMENSIONS IN PARENTHESES ARE IN METRIC.

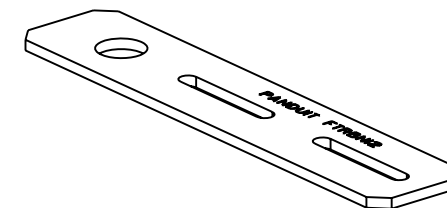

ENG. REF.: D35245BP_DC_FTRBN12_02.prt

CAD FILENAME/LAYERS		FTRBN12.pdf	
		PANDUIT CORP TINLEY PARK, ILLINOIS FIBER-DUCT 2x2, 4x4 AND FIBERRUNNER 2x2 NEW THREADED ROD BRACKET - 1/2" (M12) THREADED ROD (FTRBN12, FTRBN12M) CUSTOMER DRAWING	
		UNLESS OTHERWISE SPECIFIED, DIMENSIONAL TOLERANCES ARE: (.X) ± (.XXX) ± (.XX) ± .03 (.8) ANGLES ±	UNLESS OTHERWISE SPECIFIED, ALL DIMENSIONS ARE GIVEN IN INCHES, THIRD ANGLE PROJECTION.
DRAWN BY: TPC DATE: 11-20-96 CHK'D: CEF	MAT'L: STEEL	SCALE: NONE	DRAWING NO.: 35245-16 DWG SIZE: A

REV	DATE	BY	CHK	DESCRIPTION	ECN	R	CUST	SUP	GMBH
-	-----	---	--	K. REVISED GENERAL NOTES.	-----	--	--		
-	-----	---	--	J. REVISED PART WEIGHT. I. REVISED MATERIAL.	-----	--	--		
-	-----	---	--	H. REMOVED FTRBN58. G. REVISED DRAWING TITLE.	-----	--	--		
2	12-27-06	MSO	RN	F. REVISED CAD FILENAME. E. REVISED AND REDRAWN.	35245-16	RN	RN		