

# Carflex liquidtight fittings

## Straight fittings

For use with Carflex conduit and Carflex X-Flex conduit

Image 1



Assembly

Image 2

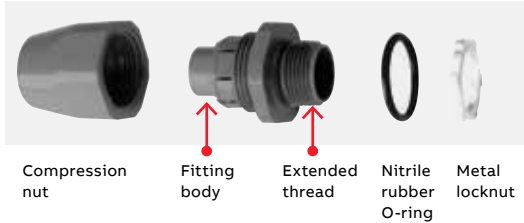

Compression nut

Fitting body

Extended thread

Nitrile rubber O-ring

Metal locknut

Image 3



Assembly

Image 4



Compression nut

Sealing ring

Ferrule

Fitting body

O-ring

Plastic locknut

### Features

- Non-conductive and non-corrosive
- Easy to install
- Resistant to oil, acid, ozone and alkaline
- Approved for indoor and outdoor locations
- Listed for “wet locations”
- Nitrile rubber O-ring for a liquidtight termination
- Temperatures up to 107 °C

### Specifications



Cat. no.	Size (in.)	Std. ctn. qty.	Std. ctn. wt. (lb)	Dimensions (in.)						Refer to Image
				A	B	C	D	E		
LT43C	3/8	50	3.6	0.55	0.75	1.60	1.30	1.40	1-2	
LT43D-NEW	1/2	50	4.2	0.56	0.91	1.62	1.30	1.40	1-2	
LT43E-NEW	3/4	50	6.6	0.56	0.91	1.88	1.61	1.71	1-2	
LT43F-NEW	1	25	5.5	0.70	1.00	2.20	1.90	2.04	1-2	
LT43G	1 1/4	5	1.5	0.71	1.16	2.50	2.17	-	3-4	
LT43H	1 1/2	5	2.0	0.75	1.36	2.78	2.43	-	3-4	
LT43J	2	5	2.5	1.00	1.45	3.33	-	-	3-4	

### Diagrams

Typ. dimension with Carflex installed

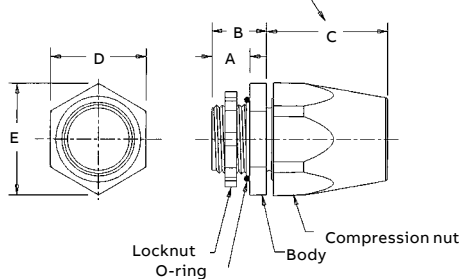

LT43C-CAR, LT43D-NEW, LT43E-NEW, LT43F

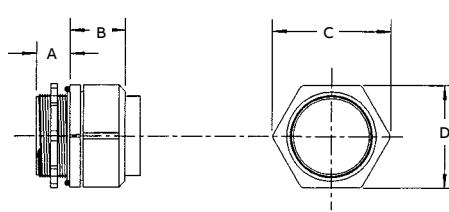

LT43G, LT43H

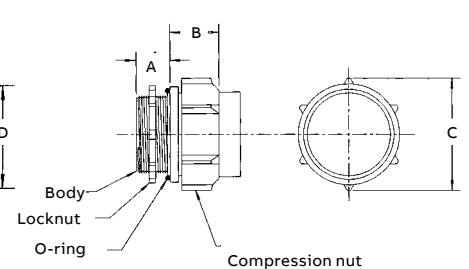

LT43J

# Carflex liquidtight fittings

## 90° Fittings

For use with Carflex conduit and Carflex X-Flex conduit

Image 1



Assembly

Image 2

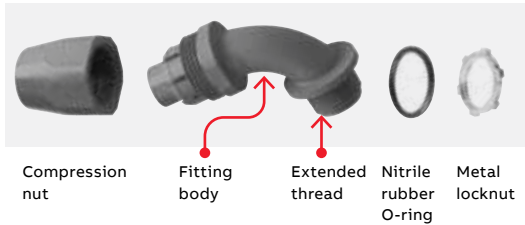

Compression nut    Fitting body    Extended thread    Nitrile rubber O-ring    Metal locknut

Image 3



Assembly

Image 4



Compression nut    Sealing ring    Ferrule    Fitting body    O-ring    Plastic locknut

### Features

- Non-conductive and non-corrosive
- Easy to install
- Resistant to oil, acid, ozone and alkaline
- Approved for indoor and outdoor locations
- Listed for “wet locations”
- Nitrile rubber O-ring for a liquidtight termination
- Temperatures up to 107 °C

### Specifications



Cat. no.	Size (in.)	Std. ctn. qty.	Std. ctn. wt. (lb)	Dimensions (in.)								Refer to Image
				A	B	C	D	E	F	G		
LT20C	3/8	50	3.6	0.56	1.44	1.44	1.56	1.39	1.26	-	1-2	
LT20D-NEW	1/2	50	4.2	0.56	1.76	2.05	1.62	1.40	1.30	1.15	1-2	
LT20E-NEW	3/4	50	6.6	0.56	2.04	2.35	1.88	1.71	1.61	1.50	1-2	
LT20F-NEW	1	25	5.5	0.70	2.01	2.01	2.26	2.04	1.90	-	1-2	
LT20G	1 1/4	5	1.5	0.75	2.50	3.55	2.48	-	-	-	3-4	
LT20H	1 1/2	5	2.0	0.75	2.80	3.98	2.77	-	-	-	3-4	
LT20J	2	5	2.5	0.94	3.48	4.56	3.33	-	-	-	3-4	

### Diagrams

