

# Wireless Technology

Project Name:	Prepared By:
Project Number:	Date:
Catalog Number:	Type:



## Tabletop Controller

120V/AC, 5V Power Supply or 3 AA Batteries  
Primary or Secondary Z-Wave Controller

### Controllers

#### FEATURES

- Blue LCD screen with icon menu navigation for easy viewing
- All ON/All OFF and Panic buttons provided for quick access
- Menu & Back buttons provide user hot keys
- Directional keypad with OK button for system navigation
- Eight shortcut buttons for favorite scene activation
- Rubber pads on bottom stabilize controller and prevent scratches on solid surfaces
- Can be surface mounted using two tear-drop holes on back of controller
- Back ledge support can be raised for angled viewing
- Intuitive user interface guides user through any chosen function on LCD
- Serves as Primary or Secondary Controller, allowing multiple controllers to be used within each network (one Primary allowed per network)
- Able to Include/Exclude and configure up to 231 devices
- Create and edit up to 64 scenes; create, edit and schedule up to 32 events
- Allows up to eight favorite scenes to be selected, prioritized and listed on LCD for quick activation using the associated eight shortcut buttons
- Replicate function allows user to duplicate information from one controller to another
- Away Mode function allows user to create "lived-in" automated lights in network while away (e.g. work day, vacation, etc.)
- Battery Status Indicator shows when battery power is low
- Primary Controller icon on LCD to indicate whether controller is a Primary or Secondary controller
- Directional keypad provides Brighten/Dim feature when a dimmer is selected
- Time and Day provided on main menu for quick reference
- Device Status feature allows the user to determine each devices' current status (e.g. Switch = On) in the network
- Child Lockout feature offers user the option to change how a device is controlled, either manually or wirelessly
- Allows user to create custom "Panic" mode to alert neighbors or emergency vehicles, or to create quick viewing of outside or inside areas
- Powered by 3 AA batteries (not supplied) or 120V/AC power supply (included)

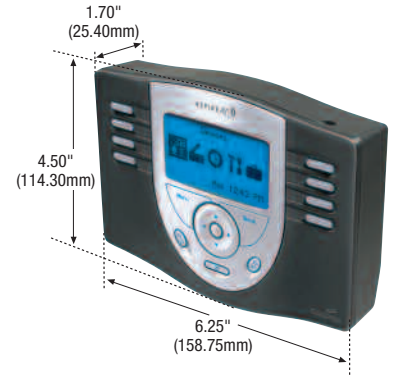

RFTDCSG

### Aspire RF Tabletop Controller



Description	Catalog Number
Tabletop Controller (3AA Batteries or AC Power Supply)	□ RFTDCSG

#### TESTING & CODE COMPLIANCE

- Complies with FCC Part 15, Class B
- Z-Wave Compliant Certified

#### MATERIAL CHARACTERISTICS

- Meets Flammability Rating: V2 per UL94
- Temperature Rating: 32°F to 104°F (0°C to 40°C)



#### Related Products

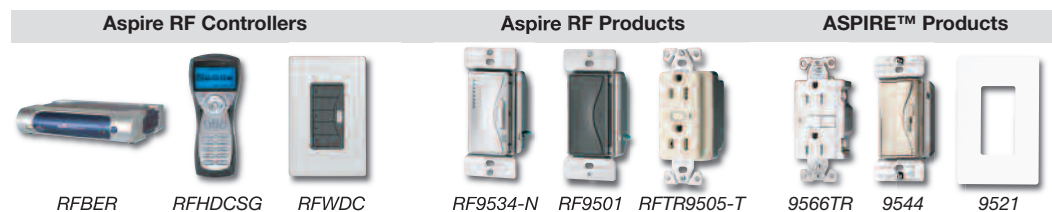

# Wireless Controller Specification & Performance Data

Project Name:	Prepared By:
Project Number:	Date:
Catalog Number:	Type:



## Tabletop Controller

120V/AC, 5V Power Supply or 3 AA Batteries  
Primary or Secondary Z-Wave Controller

### Application

Aspire RF™ Tabletop Controller (RFTDCSG) is required as an installation tool for the programming and configuration of a Cooper Wiring Devices' Z-Wave® network. The Tabletop Controller is used as a wireless controller to control and configure devices (dimmers, switches, receptacles, plug-in modules and accessories devices), scenes, events and system settings. One controller, known as the Primary is required per each Z-Wave network, but multiple controllers can be used in the network as Secondary controllers and as many secondary controllers can be used as desired within the network. Aspire RF offers users the following choices of Z-Wave compliant controllers: Handheld (RFHDCSG), Tabletop (RFTDCSG), USB (RFUSB or RFUSB-PRO) or SD Card (RFMCC). Includes 5V Power Supply, Quick Guide and User Guide.

Product Type Catalog No.	Tabletop Controller RFTDCSG
<b>Includes</b>	Tabletop Controller 5V Power Supply Quick Guide User Guide
<b>Performance</b>	Power Supply: AC Power Supply (Included) or 3 AA Batteries (not included) Estimated Normal Battery Life: 1 year Uses 300 Series Z-Wave chip @ 40Kbs
<b>Performance Consideration</b>	An Aspire RF Z-Wave® enabled device must be within 60 feet of another Z-Wave enabled device to participate in a Z-Wave wireless mesh network.
<b>Installation &amp; Programming</b>	Please reference the User Guide included with product for programming and system information. Both the User Guide and Quick Guide are accessible online at <a href="http://www.cooperwiringdevices.com/AspireRF">www.cooperwiringdevices.com/AspireRF</a> .
<b>Testing &amp; Code Compliance</b>	Complies with FCC Part 15, Class B Z-Wave Compliant Certified
<b>Material Characteristics</b>	Meets Fammability Rating: V2 per UL94 Temperature Rating: 32°F to 104°F (0°C to 40°C)
<b>Warranty</b>	5 year limited product warranty Product and performance warranties are extended to 10 years if installed as part of an Aspire RF Certified Installer System

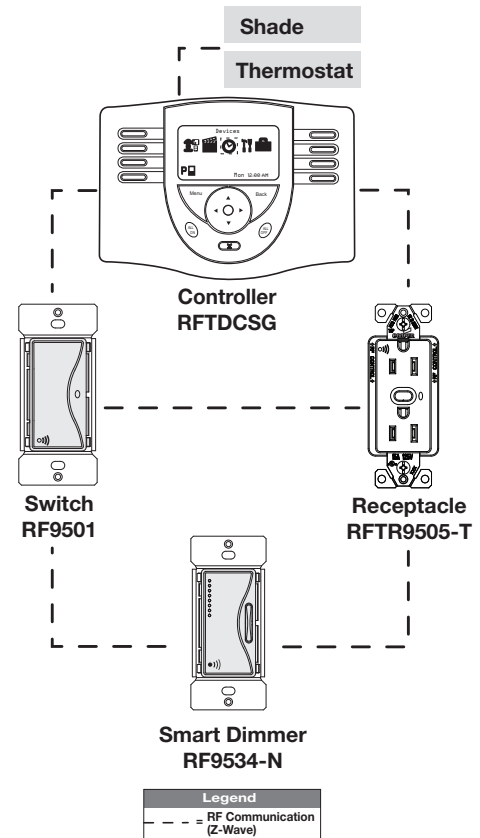

### Product Function/Layout

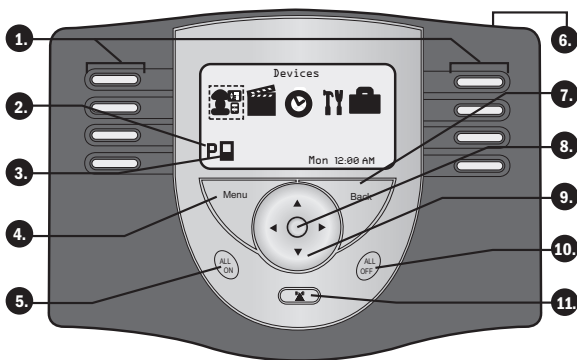

- Favorite Scene buttons**  
Eight of your favorite scenes can be accessed directly with an easy one-touch control.
- Primary Controller Callout**  
Indicates if it is the primary controller.
- Battery Status Indicator**  
Appears when battery is low on power
- Menu/Save button**  
Access the main menu and save desired settings
- ALL ON/Brighten button**  
Turn all devices in the ALL ON group on at once. Brightens selected dimmer switches.
- AC adapter plug-in**
- Back/Cancel button**  
Exit a menu screen and return to the previous menu.
- OK button**  
Use this button to select settings in menus.
- Arrow pad**  
Navigate through menus and screens, create custom names, and change various settings.
- ALL OFF/Dim button**  
Turn all devices in the ALL OFF group off at once. Dims selected dimmer switches.
- Panic button**  
Trigger a group of devices to turn off and on in a pattern that attracts attention.