

**Momentary Contact Push Button Devices, Non-Illuminated — With Two-Color Molded Legend Caps**

**Operator Only**

- Less legend cap
- Less contact blocks

Button Type	Type 4/13	Type 4/4X/13
	Cat. No.	Cat. No.
Flush	<b>800T-A00</b>	<b>800H-AR00</b>
Extended	<b>800T-B00</b>	<b>800H-BR00</b>



Cat. No. 800T-A00 with  
 Cat. No. 800T-LC103W  
 installed



Cat. No. 800H-BR00 with  
 Cat. No. 800T-LC604  
 installed

**Legend Caps**

Text	Cap Color	Text Color	Cat. No.
	Green	White	800T-LC101W
START			800T-LC103W
ON			800T-LC105W
START / I			800T-LC121W
O			800T-LC202W
STOP	Black	White	800T-LC204W
RESET			800T-LC207W
↑			800T-LC208W
FORWARD			800T-LC209W
REVERSE			800T-LC210W
JOG			800T-LC212W
UP			800T-LC213W
DOWN			800T-LC214W
RAISE			800T-LC215W
LOWER			800T-LC216W

Text	Cap Color	Text Color	Cat. No.
IN	Black	White	800T-LC217W
OUT			800T-LC218W
HIGH			800T-LC219W
LOW			800T-LC220W
STOP / O			800T-LC222W
	White	Black	800T-LC501B
START			800T-LC503B
↑			800T-LC508B
START / I			800T-LC521B
O	Red	White	800T-LC602W
STOP			800T-LC604W
OFF			800T-LC606W
STOP / O			800T-LC622W
RESET	Blue	White	800T-LC707W
R			800T-LC711W

**Note:** Package Qty. = 1

**800 T - A 103W A**

*a b c d e*

**a**

Protection Rating	
Code	Description
T	Metal, Type 4/13
H	Plastic, Type 4/4X/13

**b**

Finger-Safe Guards	
Code	Description
Blank	No guards
C	Guards on terminals

**c**

Operator Type		
800T Type 4/13	Description	800H Type 4/4X/13
Code		Code
A	Flush head	AR
B	Extended head	BR

**d**

Cap Text/Color					
Code	Text	Color			
		Cap	Text		
101W		Green	White		
103W	START				
105W	ON				
121W	START / I				
202W	O				
204W	STOP	Black	White		
207W	RESET				
208W	↑				
209W	FORWARD				
210W	REVERSE				
212W	JOG				
213W	UP				
214W	DOWN				
215W	RAISE				
216W	LOWER				
217W	IN			White	Black
218W	OUT				
219W	HIGH				
220W	LOW				
222W	STOP / O				
501B		Red	White		
503B	START				
508B	↑				
521B	START / I				
602W	O	Blue	White		
604W	STOP				
606W	OFF				
622W	STOP / O				
707W	RESET	Blue	White		
711W	R				

**e**

Contact Block(s)	
Code	Description
Blank	No contacts
Standard	
D1	1 N.O.
D2	1 N.C.
D3	1 N.O.E.M.
D4	1 N.C.L.B.
D5	1 N.O. (Mini)
D6	1 N.C. (Mini)
A1	1 N.C.L.B. - 1 N.O.
A2	2 N.O.‡
A4	2 N.C.
A7	1 N.C.L.B. - 1 N.C.
A	1 N.O. - 1 N.C.
B	2 N.O. - 2 N.C.
Class 1, Div. 2/Zone 2	
Sealed Switch	
D1P	1 N.O.
D2P	1 N.C.
AP	1 N.O. - 1 N.C.
BP	2 N.O. - 2 N.C.
Stackable Sealed Switch	
D1Y	1 N.O.
D2Y	1 N.C.
A2Y	2 N.O.
A4Y	2 N.C.
AY	1 N.O. - 1 N.C.
BY	2 N.O. - 2 N.C.

**e (cont'd)**

Contact Block(s)	
Code	Description
PenTUFF (Low Voltage)	
D1V	1 N.O.
D2V	1 N.C.
D3V	1 N.O.E.M.
D4V	1 N.C.L.B.
AV	1 N.O. - 1 N.C.
BV	2 N.O. - 2 N.C.
Time Delay	
T	1 N.O. Depress close, delayed opening
S	1 N.C. Depress open, delayed closure
Snap Action	
M	1 N.O. - 1 N.C.
N	2 N.O. - 2 N.C.
Class 1, Div. 2/Zone 2	
Logic Reed	
D1R	1 N.O.
D2R	1 N.C.
A2R	2 N.O.‡
A4R	2 N.C.
AR	1 N.O. - 1 N.C.
BR	2 N.O. - 2 N.C.

‡ A2 and A2R contact blocks cannot be stacked upon, but can stack upon other contact blocks.



**Specifications\***

Electrical Ratings		
Contact ratings	Refer to the contact ratings tables on page 10-4.	
Dielectric strength	2200V for one minute, 1300V for one minute (Logic Reed)	
Electrical design life cycles	1 000 000 at max. rated load, 200 000 at max. rated load (Logic Reed)	
Mechanical Ratings		
Vibration	10...2000 Hz, 1.52 mm displacement (peak-to-peak) max./ 10 G max. (except Logic Reed)	
Shock	1/2 cycle sine wave for 11 ms ≥ 25 G (contact fragility) and no damage at 100 G	
Degree of protection	Type 1/4/12/13 (800T); Type 1/4/4X/12/13 (800H); EN/IEC 60529 IP66/65	
Mechanical design life cycles		
Push buttons	(Momentary, non-illuminated)	10 000 000 min.
	(Momentary, illuminated)	250 000 min.
	(Push-pull/twist-to-release)	250 000 min.
Selector switches	(Non-illuminated)	1 000 000 min.
	(Illuminated, key-operated)	200 000 min.
Potentiometers	25 000 min.	
All other devices	200 000 min.	
Contact operation	Shallow, mini, and low-voltage contact blocks: Slow, double make and break Logic Reed and sealed switch contact blocks: Single break magnetic	
Wire gauge/Terminal screw torque	#18...14 AWG (#18...10 Max Duty) / 6...8 lb•in	
Typical operating forces		
Operators without contact blocks	Flush, extended button, standard mushroom, jumbo plastic mushroom: 2 lbs max. Jumbo and extended aluminum mushroom head: 3.95 lbs max. Maintained selector switch: 3.6 in•lb max.	
Spring return selector switches	3.6 in•lb to stop, 0.2 in•lb to return	
Illuminated push buttons and push-to-test pilot lights	5 lb max.	
2-position push-pull	8.0 lb max. push or pull	
3-position push-pull	8 lb max. push to in position or pull to center position (15 lb max. pull to out position)	
Twist-to-release or push-pull	9 lbs max. push or pull 30 in•oz max. twist, 6 in•oz minimum return	
Potentiometer	Rotational torque 3...12 in•oz; stopping torque 12 in•lb (minimum)	
Contact blocks	Standard	1 lb
	Logic Reed	1 lb max.
	Sealed switch	3 lb max. at 0.205 in. plunger travel
	Stackable sealed switch	1 lb max.
	MaxDuty	1.4 lb max.
	PenTUFF	1.4 lb max.
Self Monitoring	1.6 lb	
Environment		
Temperature range	Operating	-40...+131 °F (-40...+55 °C)
	Storage	-40...+185 °F (-40...+85 °C)
<b>Note:</b> Operating temperatures below freezing are based on the absence of moisture and liquids. Consult your local Rockwell Automation sales office or Allen-Bradley distributor for use in lower temperature applications.		
Humidity	50...95% RH from 77...140 °F (25...60 °C) per Procedure IV of MIL-STD-810C, Method 507.1 cycling test	

\* Performance Data — See Important- 3.

# 30.5 mm Push Buttons

## Approximate Dimensions

Dimensions in inches (millimeters). Dimensions are not intended to be used for manufacturing purposes.

### Push Buttons and Switches (Bul. 800T Only)

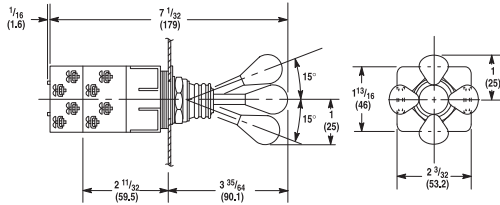

**2-3-4 Way Switch**  
**Shipping Wt. with 2 Contact Blocks 6 oz (0.17 kg)**  
**Shipping Wt. with 4 Contact Blocks 8-1/2 oz (0.24 kg)**

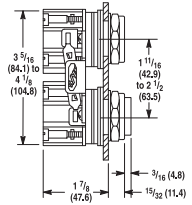

**Mechanically Interlocked Maintained Contact Push Button**  
**Shipping Wt. 1 lb (0.45 kg)**

### Push Buttons and Pilot Lights

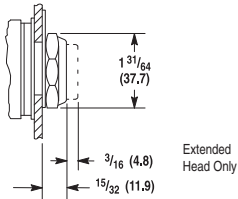

**Flush and Extended Head Push Button**  
**Shipping Wt. 5-1/2 oz (0.15 kg)**

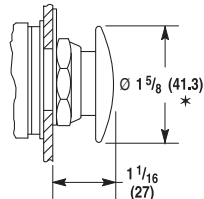

**Mushroom Head Push Button**  
**Shipping Wt. 7-1/2 oz (0.21 kg)**

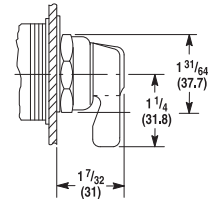

**Non-Illuminated Knob Lever and Standard Knob Selector Switch**  
**Shipping Wt. 6 oz (0.17 kg)**

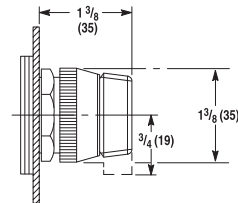

**Illuminated Knob Lever and Standard Knob Selector Switch**  
**Shipping Wt. 6 oz (0.17 kg)**

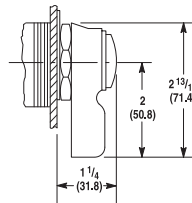

**Wing Lever Selector Switch**  
**Shipping Wt. 8 oz (0.22 kg)**

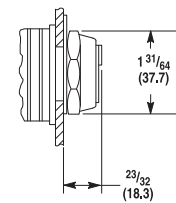

**Coin Slot Selector Switch**  
**Shipping Wt. 6 oz (0.17 kg)**

\* Except jumbo which is 2-1/4 (57.2).

### Operator Extension in Front of Panel (Bul. 800T Only)

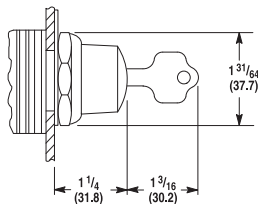

**Key Operated Selector Switch**  
**Shipping Wt. 12 oz (0.34 kg)**

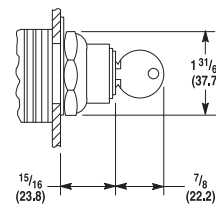

**Push Button with Cylinder Lock**  
**Shipping Wt. 12 oz (0.34 kg)**

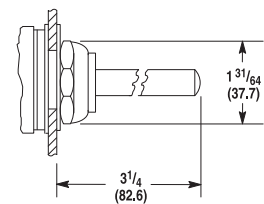

**Wobble Stick**  
**Shipping Wt. 9 oz (0.25 kg)**

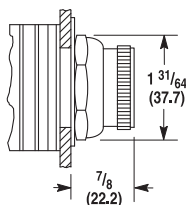

**Selector Push Button**  
**Shipping Wt. 6 oz (0.17 kg)**

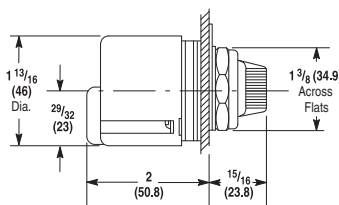

**Type J Potentiometer Unit**  
**Shipping Wt. 4 oz (0.11 kg)**

