

Accessories

End stops

The end stops are mounted at the extremity of the terminal board assembly, giving additional support to the terminal blocks. For various types of marking, refer to the marker section

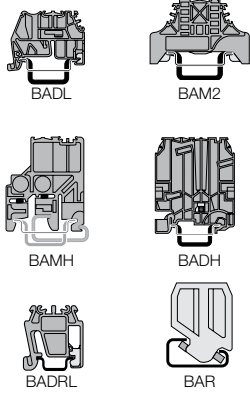

Description	Type	Packaging	Catalog number
End stop screwless DIN 3	grey	BADL 9 mm	50 039990302
End stop with screws DIN 3	light grey	BAM2 10 mm	50 039996701
	grey	BAM2 10 mm	50 020635116
	beige	BAM2 10 mm	50 029635100
High end stop with screws DIN 1 and DIN 3	grey	BAMH 9.1 mm	50 011483600
	beige	BAMH 9.1 mm	50 019483601
High end stop with screws DIN 3	grey	BADH 12 mm	50 011690027
End stop for miniblocks DIN 2	grey	BADRL 6.5 mm	50 019942021
Reversible end stop DIN 1	beige	BAR 10 mm	50 016451924

Mounting rails

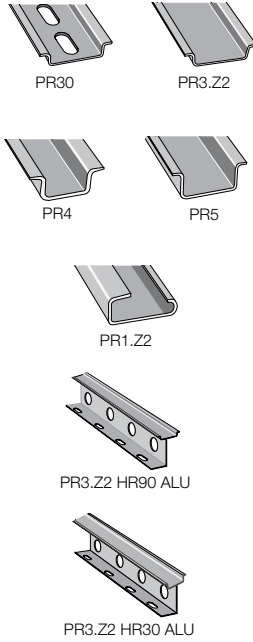

Description	Type	Packaging	Catalog number
Symmetrical white passivated galvanized steel prepunched rail	PR30	1 m	1 010150804
		2 m	1 017322005
Symmetrical white passivated galvanized steel rail	PR3.Z2	1 m	1 010151310
		2 m	1 017430017
Symmetrical white passivated galvanized steel rail	PR5	1 m	1 010151512
		2 m	1 016870022
Symmetrical white passivated galvanized steel rail	PR4	1 m	1 010151714
		2 m	1 016850012
Asymmetrical zinc white passivated galvanized steel rail	PR2	1 m	1 010167300
Extruded aluminum, prepunched	PR3.Z2 HR90 ALU	1 m	1 XUS001735
		2 m	1 XUS001736
Extruded aluminum, prepunched	PR3.Z2 HR30 ALU	1 m	1 XUS001737
		2 m	1 XUS001738

Test devices

Description	Type	Packaging	Catalog number
Test plug DIA. 2 mm	FC2		10 000786526
Test plug DIA. 4 mm	FC4		10 016786001
Test socket DIA. 2 mm for screw clamp/ ADO up to 8 mm spacing	one deck	AL2	50 016304321
	double deck	AL2	50 016307000
Test socket DIA. 4 mm for screw clamp blocks 8, 10, 12 mm spacing	AL4		50 016326201

Shield connectors

Description	Type	Packaging	Catalog number
For screw clamp blocks: MA 2,5/2 ; MA 2,5/5.SNB ; M 4/6; MA 2,5/5.D2; M 4/6.D2	CBM5		50 017874514
	CBM5D		50 017353024
For spring clamp blocks: D 2,5/5.2L ; D 2,5/5.1.3L ; D 2,5/5.1.4L ; D 2,5/5.SNBT.2L	CBD5.2L		50 029107724
For ADO blocks: D 1/5.ADO ; D 1,5/6.ADO ; D 2,5/6.ADO ; D 4/6.ADO; D 2,5/5.SN.ADO ; D 4/6.SN.ADO; D 1/5.SNT2.ADO ; D 1,5/6.SNT2.ADO; D 4/6.D2.ADO ; D 1,5/6.D2.ADO	CBM5		50 017874514
	CBD1		1 017963406
	CBD2		50 017963507
	CBD2S		50 017840814

Shield terminals for collector bar

Shield diameter	Type	Packaging	Catalog number
1,5 - 6,5	SFB.B1		10 020517014
5 - 11	SFB.B2		10 020517101
10 - 17	SFB.B3		10 020517202
16 - 24	SFB.B4		10 020517303
Collector bar 18 x 3 x 1000 mm	BO 318		10 020517505
Bar holder (isolated from ground)	DSPBO.PI		10 020517606
Bar holder (connected to the mounting rail)	DSPBO.P		10 020517707

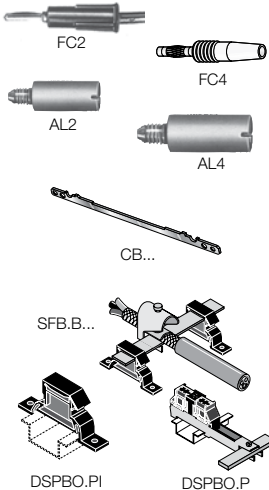

PR30 Mounting rail

Terminal block accessories

RoHS
RoHS

2000 mm 78 in Length

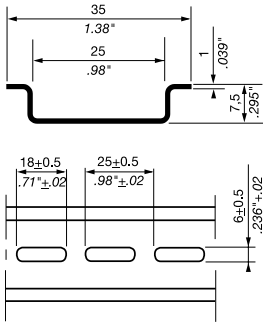

10

Features and Benefits

- Pre-punched symmetrical mounting rail;
- The oblong holes ease the mounting and allow to use existing and/or numerous fixings;
- Particularly well designed for fixing onto back-plates and for terminal assemblies of small dimensions

Ordering Details

Description	Color	Type	Catalog Number	Packing pieces	Weight 1 pc (g)
Prepunched rail		PR30	017322005	20	

Main Technical Data

Material	Zinc plating and passivation steel		
Rail	TH 35-7.5		
	IEC	cULus - CSA	
Equivalent E-Cu cross section			

Mounting Instructions

- In order to guarantee the performances and security of your installation, please ensure the rail and its fixings can withstand the static and dynamic loads of the components mounted on it;
- To prevent the rail from flexing (1 mm 0.039 in rail thickness only), fixing is recommended every 250 mm 9.842 in;
- To prevent any issues during mounting, screw heads used for rail fixing should not protrude from the rail (7,5 mm 0.295 in rail height only).

PR3.Z2 Mounting rail

Terminal block accessories

RoHS
RoHS

2000 mm 78 in Length

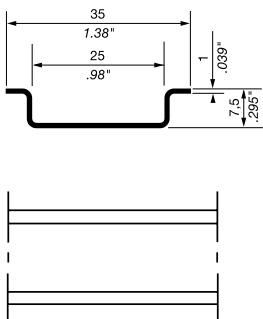
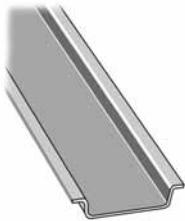

Features and Benefits

- Symmetrical mounting rail complying with IEC60715;
- Particularly well designed for fixing onto back-plates and for terminal assemblies of small dimensions

Ordering Details

Description	Color	Type	Catalog Number	Packing pieces	Weight 1 pc (g)
		PR3.Z2	017430017	20	

Main Technical Data

Material	Zinc plating and passivation steel		
Rail	TH 35-7.5		
	IEC	cULus - CSA	
Equivalent E-Cu cross section	16 mm ²	4 AWG	

Mounting Instructions

- In order to guarantee the performances and security of your installation, please ensure the rail and its fixings can withstand the static and dynamic loads of the components mounted on it;
- To prevent the rail from flexing (1 mm 0.039 in rail thickness only), fixing is recommended every 250 mm 9.842 in;
- To prevent any issues during mounting, screw heads used for rail fixing should not protrude from the rail (7,5 mm 0.295 in rail height only).