

## Rail offset brackets, angled

Zinc bichromate plated steel

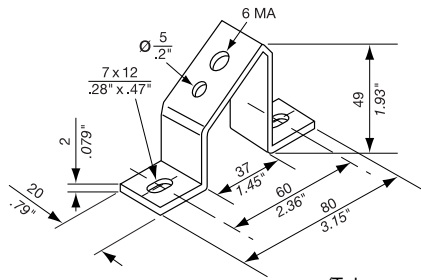

(Tolerance ±2 mm, ±0.08 in)

**TS4-SM6** 0306 022.24

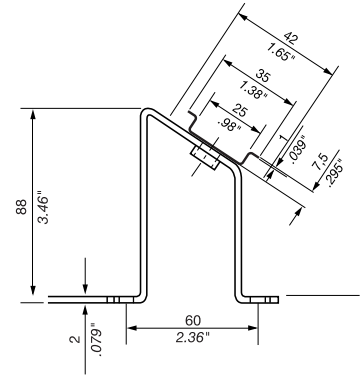
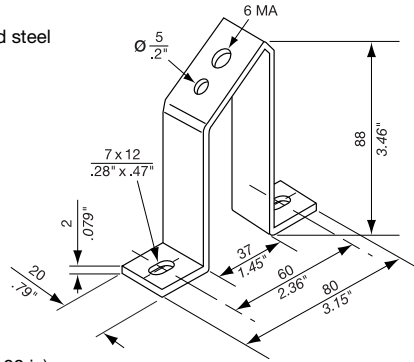

**TS8-SM6** 0306 023.25

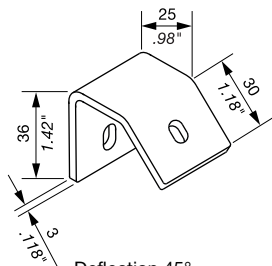

**TS.45** 0008 521.26

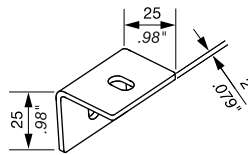

**TS.90** 0008 520.01

### DIN rail spacer/isolator

Ceramic style spacer isolates a DIN rail from the chassis. Brass threaded inserts, at each end of the isolator, allow you to screw attach the isolator to the chassis and DIN rail.

Height	P/N	
	mm	in
20	0.79	<b>0106 393.20</b>
25	0.98	<b>0106 394.25</b>
30	1.18	<b>0106 395.30</b>
40	1.57	<b>0106 396.40</b>
50	1.97	<b>0106 397.50</b>
60	2.36	<b>0106 398.60</b>
70	2.76	<b>0106 399.75</b>

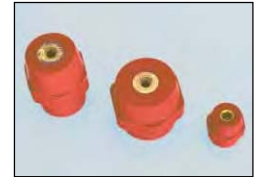

## Rail offset brackets, vertical offset

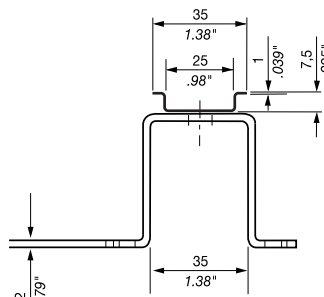
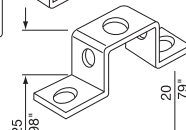
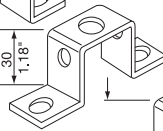
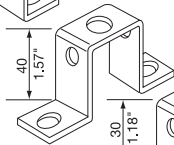
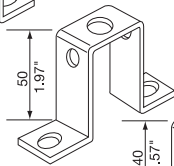
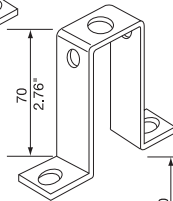
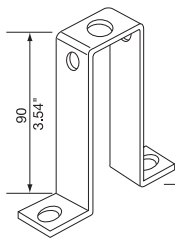

Top mounted rail

Type	Height		Old P/N	New P/N
	mm	in		
<b>TS 0201-SM6</b>	20	0.79	<b>304 200.26</b>	<b>0101 653.04</b>
<b>TS 0251-SM6</b>	25	0.98	<b>N/A</b>	<b>0101 930.22</b>
<b>TS 0301-SM6</b>	30	1.18	<b>N/A</b>	<b>0101 654.05</b>
<b>TS 0401-SM6</b>	40	1.57	<b>304 201.13</b>	<b>0101 655.06</b>
<b>TS 0501-SM6</b>	50	1.97	<b>N/A</b>	<b>0101 656.07</b>
<b>TS 0706-SM6</b>	70	2.76	<b>304 202.14</b>	<b>0101 657.00</b>
<b>TS 0904-SM6</b>	90	3.54	<b>304 203.15</b>	<b>0101 658.11</b>
<b>Screw SM6*</b>			<b>304 234.03</b>	<b>0101 659.12</b>

\* Screw for bracket is flat head, allen key. Use this screw to mount rail to bracket.

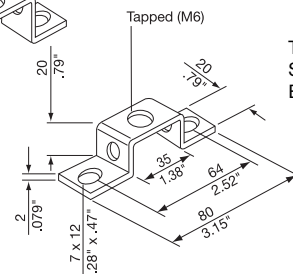

Top hole tapped (M6)  
Side holes unthreaded  
Bottom mounting holes oblong