

General information Mounting

Exploded view

Contact block

Single pole with making or breaking contact

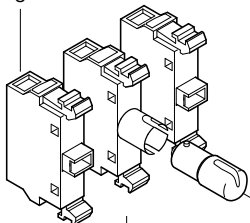

Holder

Available either for three or five blocks in one single row. Additional blocks can be stacked on holders for three blocks.

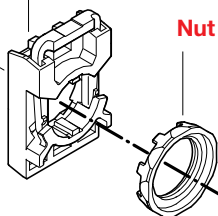

Nut

Legend plates

Of aluminum with slots that guide the legend plate and the operator into the correct position. Please, see the chapter 'legend plates' for more information.

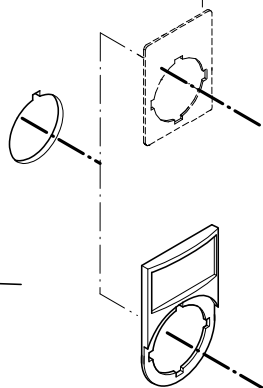

Lamp block

Illuminated pushbuttons, illuminated selector switches and pilot lights have a lamp block in the center position of the holder.

Operator

Buttons, lenses and handles in several colors. Illuminated or non-illuminated.

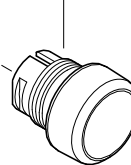

Legend plate holder

Of black plastic. Insert of brushed aluminum. Please, see the chapter 'legend plates' for more information.

Bezels

Pushbuttons, selector switches and toggle switches with bezel in black plastic, chrome metal are available.

8

Easy to mount

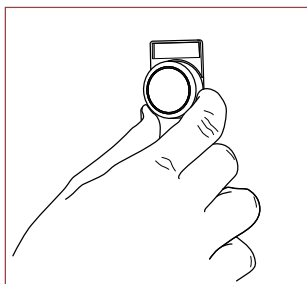

The operator is to be inserted from the front.....

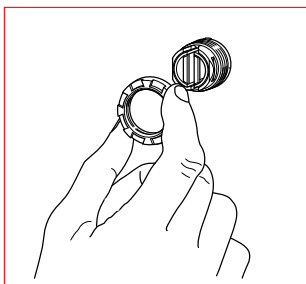

...and secured at the back with a nut.

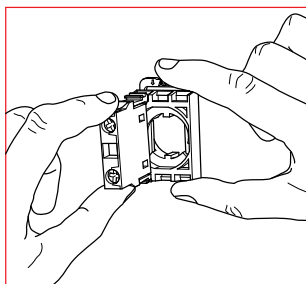

The contact blocks/lamp block are then snapped on to the holder...

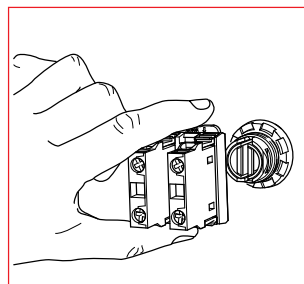

...and the holder snaps on to the operator.

...and to remove

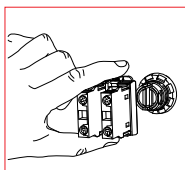
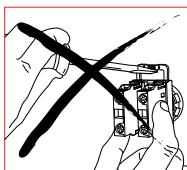

Press down the spring on the holder and pull the holder from the actuator.

Selection Guide

Pilot Devices
Modular Range
22mm

Pushbuttons and Mushroom pushbuttons

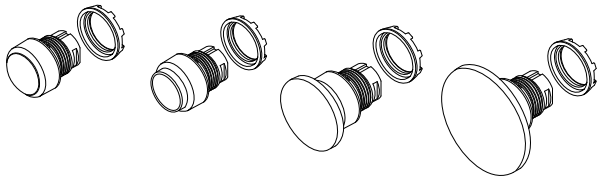

Contact block/lamp block combinations

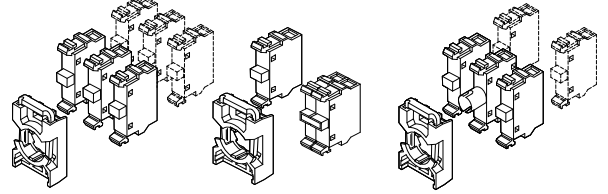

Double pushbuttons

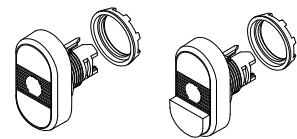

Contact block/lamp block combinations

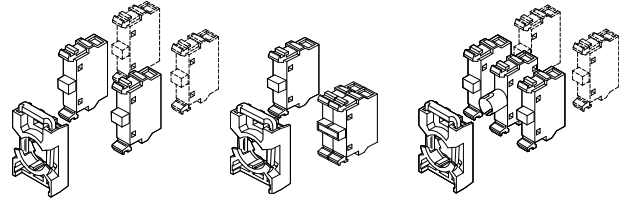

Emergency stop pushbuttons

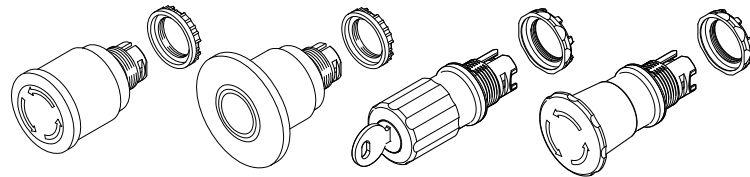

Contact block/lamp block combinations

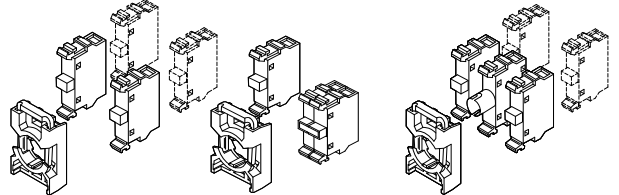

Selector switches

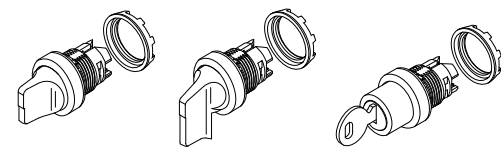

Contact block/lamp block combinations

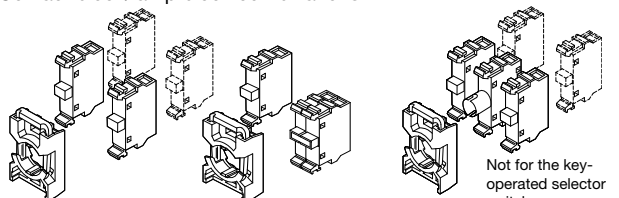

Not for the key-operated selector switches

Toggle switches

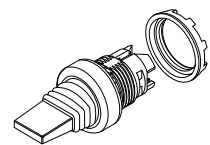

Contact block combinations

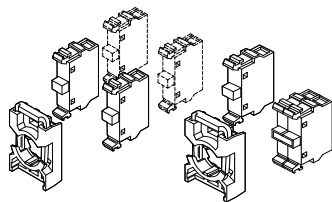

Definite purpose push-buttons

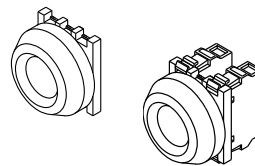

Reset pushbuttons

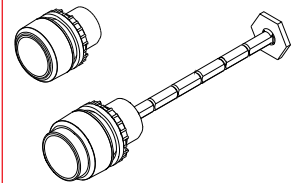

Pilot lights

Lamp block combination

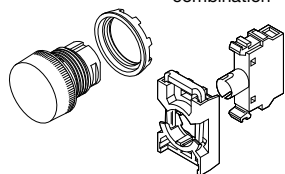

Buzzers



Potentiometers



2-position selector switches Non-illuminated

8

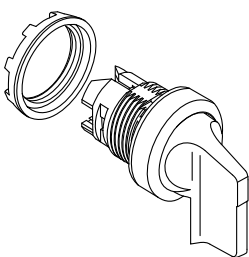
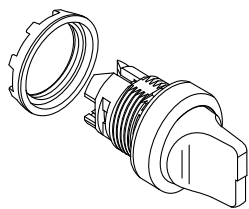

Bezel in black plastic as standard

Bezel in metal:

Replace '1' in the:

Catalog No. M2SSX-1 0X

Ref. Code 1SFA61 XXX R 1XXX

3 for metal bezel

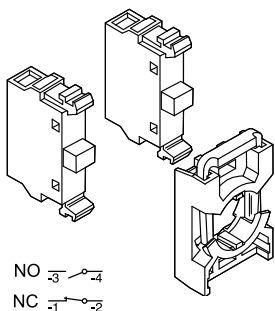

NO $\overline{3}$ $\overline{4}$
NC $\overline{1}$ $\overline{2}$

Contact functions

Block positions as seen from operator front.

Handle position	Left block	Right block
A (B)	O	O
C	x	x

O = not actuated (normal state)
x = actuated (state changed)

Operator ...

Symbol	Handle color	Catalog No.	Ref. Code	List Price
with short handle ①				
Maintained				
	Red	M2SS1-10R	1SFA 611 200 R1001	\$ 11.00
	Black	M2SS1-10B	1SFA 611 200 R1006	
	Grey	M2SS1-10U	1SFA 611 200 R1007	
Maintained				
	Red	M2SS2-10R	1SFA 611 201 R1001	\$ 11.00
	Black	M2SS2-10B	1SFA 611 201 R1006	
	Grey	M2SS2-10U	1SFA 611 201 R1007	
Momentary, spring return from C to B				
	Red	M2SS3-10R	1SFA 611 202 R1001	14.00
	Black	M2SS3-10B	1SFA 611 202 R1006	
	Grey	M2SS3-10U	1SFA 611 202 R1007	
with long handle ①				
Maintained				
	Red	M2SS4-10R	1SFA 611 203 R1001	11.00
	Black	M2SS4-10B	1SFA 611 203 R1006	
	Grey	M2SS4-10U	1SFA 611 203 R1007	
Maintained				
	Red	M2SS5-10R	1SFA 611 204 R1001	14.00
	Black	M2SS5-10B	1SFA 611 204 R1006	
	Grey	M2SS5-10U	1SFA 611 200 R1007	
Momentary, spring return from C to B				
	Red	M2SS6-10R	1SFA 611 205 R1001	14.00
	Black	M2SS6-10B	1SFA 611 205 R1006	
	Grey	M2SS6-10U	1SFA 611 205 R1007	

Contact blocks and holder

Blocks	Catalog No.	Ref. Code	List Price
1 NO with holder	MCBH-10	1SFA 611 605 R1101	\$ 10.00
1 NC with holder	MCBH-01	1SFA 611 605 R1110	10.00
2 NO with holder	MCBH-20	1SFA 611 605 R1102	18.00
2 NC with holder	MCBH-02	1SFA 611 605 R1120	18.00
1 NO + 1 NC with holder	MCBH-11	1SFA 611 605 R1111	18.00
1 NO without holder	MCB-10	1SFA 611 610 R1001	8.00
1 NC without holder	MCB-01	1SFA 611 610 R1010	8.00
Holder for 3 blocks	MCBH-00	1SFA 611 605 R1100	2.00

Ordering example

Requested: A non-illuminated modular selector switch. Black.

Maintained.

Handle positions: A and C

With 2 NC contacts

Ref.: 1 piece of M2SS2-10B + 1 piece of MCBH-02

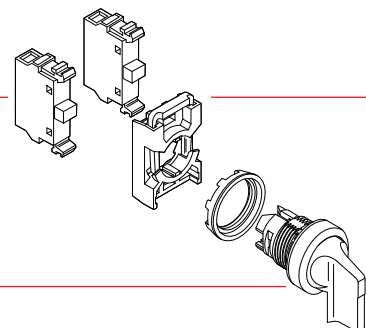

① No contact block in the center position

3-position selector switches

Non-illuminated

Pilot Devices
Modular Range
22mm

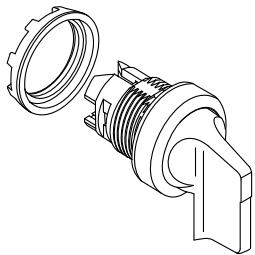
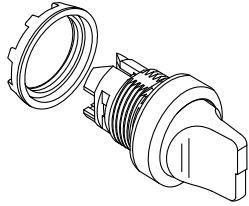

Bezel in black plastic as standard
Bezel in metal:
Replace '1' in the:
Catalog No. M3SSX-1 0X
Ref. Code 1SFA611XXX R 1XXX
3 for metal bezel

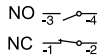
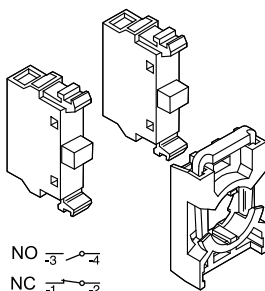

Contact functions

Block positions as seen from operator front.

Handle position	Left block	Right block
A	x	O
B	O	O
C	O	x

Operator ...

Symbol	Handle color	Catalog No.	Ref. Code	List Price
with short handle ①				
Maintained				
	Red	M3SS1-10R	1SFA 611 210 R1001	\$ 11.00
	Black	M3SS1-10B	1SFA 611 210 R1006	
	Grey	M3SS1-10U	1SFA 611 210 R1007	
Momentary, spring return from A to B and from C to B				
	Red	M3SS2-10R	1SFA 611 211 R1001	14.00
	Black	M3SS2-10B	1SFA 611 211 R1006	
	Grey	M3SS2-10U	1SFA 611 211 R1007	
Momentary, spring return from C to B				
	Red	M3SS3-10R	1SFA 611 212 R1001	14.00
	Black	M3SS3-10B	1SFA 611 212 R1006	
	Grey	M3SS3-10U	1SFA 611 212 R1007	
Momentary, spring return from A to B				
	Red	M3SS7-10R	1SFA 611 216 R1001	14.00
	Black	M3SS7-10B	1SFA 611 216 R1006	
	Grey	M3SS7-10U	1SFA 611 216 R1007	

with long handle ①

Maintained				
	Red	M3SS4-10R	1SFA 611 213 R1001	11.00
	Black	M3SS4-10B	1SFA 611 213 R1006	
	Grey	M3SS4-10U	1SFA 611 213 R1007	
Momentary, spring return from A to B and from C to B				
	Red	M3SS5-10R	1SFA 611 214 R1001	14.00
	Black	M3SS5-10B	1SFA 611 214 R1006	
	Grey	M3SS5-10U	1SFA 611 214 R1007	
Momentary, spring return from C to B				
	Red	M3SS6-10R	1SFA 611 215 R1001	14.00
	Black	M3SS6-10B	1SFA 611 215 R1006	
	Grey	M3SS6-10U	1SFA 611 215 R1007	
Momentary, spring return from A to B				
	Red	M3SS8-10R	1SFA 611 217 R1001	14.00
	Black	M3SS8-10B	1SFA 611 217 R1006	
	Grey	M3SS8-10U	1SFA 611 217 R1007	

Contact blocks and holder

Blocks	Catalog No.	Ref. Code	List Price
1 NO with holder	MCBH-10	1SFA 611 605 R1101	\$ 10.00
1 NC with holder	MCBH-01	1SFA 611 605 R1110	10.00
2 NO with holder	MCBH-20	1SFA 611 605 R1102	18.00
2 NC with holder	MCBH-02	1SFA 611 605 R1120	18.00
1 NO + 1 NC with holder	MCBH-11	1SFA 611 605 R1111	18.00
1 NO without holder	MCB-10	1SFA 611 610 R1001	8.00
1 NC without holder	MCB-01	1SFA 611 610 R1010	8.00
Holder for 3 blocks	MCBH-00	1SFA 611 605 R1100	2.00

Center position connection detail

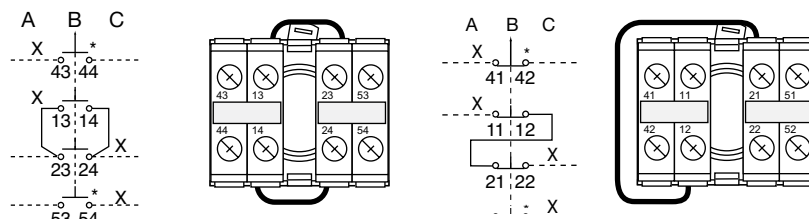

① No contact block in center position

2-position selector switches Illuminated

8

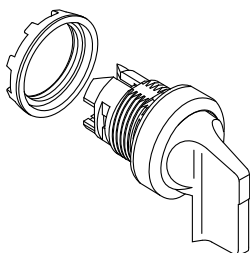
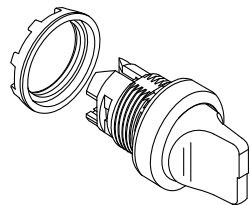

Bezel in black plastic as standard

Bezel in metal:

Replace '1' in the:

Catalog No. M2SSX-1 0X

Ref. Code 1SFA61 XXX R 1XXX

3 for metal bezel

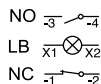
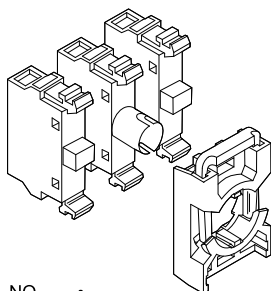

Operator ...

Symbol	Handle color	Catalog No.	Ref. Code	List Price
--------	--------------	-------------	-----------	------------

with short handle ①

Maintained



Red	M2SS1-11R	1SFA 611 200 R1101	\$ 17.00
Green	M2SS1-11G	1SFA 611 200 R1102	
Yellow	M2SS1-11Y	1SFA 611 200 R1103	
Blue	M2SS1-11L	1SFA 611 200 R1104	
Clear	M2SS1-11C	1SFA 611 200 R1108	

Maintained



Red	M2SS2-11R	1SFA 611 201 R1101	17.00
Green	M2SS2-11G	1SFA 611 201 R1102	
Yellow	M2SS2-11Y	1SFA 611 201 R1103	
Blue	M2SS2-11L	1SFA 611 201 R1104	
Clear	M2SS2-11C	1SFA 611 201 R1108	

Momentary, spring return from C to B



Red	M2SS3-11R	1SFA 611 202 R1101	26.00
Green	M2SS3-11G	1SFA 611 202 R1102	
Yellow	M2SS3-11Y	1SFA 611 202 R1103	
Blue	M2SS3-11L	1SFA 611 202 R1104	
Clear	M2SS3-11C	1SFA 611 202 R1108	

with long handle ①

Maintained



Red	M2SS4-11R	1SFA 611 203 R1101	17.00
Green	M2SS4-11G	1SFA 611 203 R1102	
Yellow	M2SS4-11Y	1SFA 611 203 R1103	
Blue	M2SS4-11L	1SFA 611 203 R1104	
Clear	M2SS4-11C	1SFA 611 203 R1108	

Maintained



Red	M2SS5-11R	1SFA 611 204 R1101	17.00
Green	M2SS5-11G	1SFA 611 204 R1102	
Yellow	M2SS5-11Y	1SFA 611 204 R1103	
Blue	M2SS5-11L	1SFA 611 204 R1104	
Clear	M2SS5-11C	1SFA 611 204 R1108	

Momentary, spring return from C to B



Red	M2SS6-11R	1SFA 611 205 R1101	26.00
Green	M2SS6-11G	1SFA 611 205 R1102	
Yellow	M2SS6-11Y	1SFA 611 205 R1103	
Blue	M2SS6-11L	1SFA 611 205 R1104	
Clear	M2SS6-11C	1SFA 611 205 R1108	

Contact blocks, lamp block and holder ②

Blocks	Catalog No.	Ref. Code	List Price
1 NO + 1 LB with holder	MCBH-101	1SFA 611 605 R1201	\$ 27.50
1 NC + 1 LB with holder	MCBH-011	1SFA 611 605 R1210	27.50
2 NO + 1 LB with holder	MCBH-201	1SFA 611 605 R1202	35.50
2 NC + 1 LB with holder	MCBH-021	1SFA 611 605 R1220	35.50
1 NO + 1 NC with holder	MCBH-111	1SFA 611 605 R1211	35.50
1 NO without holder	MCB-10	1SFA 611 610 R1001	8.00
1 NC without holder	MCB-01	1SFA 611 610 R1010	8.00
Lamp block for 2 W, max 230 V AC/DC bulb or LED	MLB-1	1SFA 611 620 R1001	17.50
Holder for 3 blocks	MCBH-00	1SFA 611 605 R1100	2.00

Contact functions See Page 8.12

Ordering example See Page 8.12

① No contact block in the center position, reserved for lamp block.

② Lamp block MLB-1. Bulb not included. Other lamp block see Accessories, bulb max 1.2 W.

3-position selector switches Illuminated

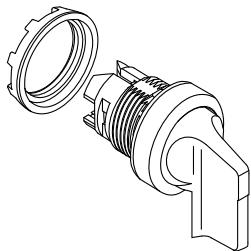
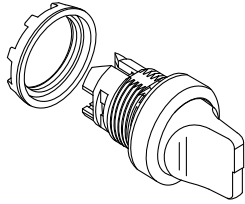

Bezel in black plastic as standard
Bezel in metal:
Replace '1' in the:
Catalog No. M3SSX-1 0X
3 for metal bezel

Center position connection detail

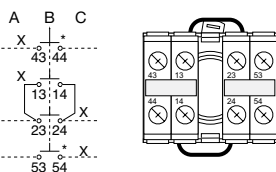

* Contacts may be N.O. or N.C.

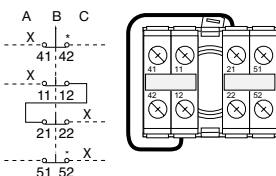

* Contacts may be N.O. or N.C.

Operator ...

Symbol	Handle color	Catalog No.	Ref. Code	List Price
with short handle ①				
Maintained				
	Red	M3SS1-11R	1SFA 611 210 R1101	\$ 17.00
	Green	M3SS1-11G	1SFA 611 210 R1102	
	Yellow	M3SS1-11Y	1SFA 611 210 R1103	
	Blue	M3SS1-11L	1SFA 611 210 R1104	
	Clear	M3SS1-11C	1SFA 611 210 R1108	
Momentary, spring return from A to B and from C to B				
	Red	M3SS2-11R	1SFA 611 211 R1101	26.00
	Green	M3SS2-11G	1SFA 611 211 R1102	
	Yellow	M3SS2-11Y	1SFA 611 211 R1103	
	Blue	M3SS2-11L	1SFA 611 211 R1104	
	Clear	M3SS2-11C	1SFA 611 211 R1108	
Momentary, spring return from C to B				
	Red	M3SS3-11R	1SFA 611 212 R1101	26.00
	Green	M3SS3-11G	1SFA 611 212 R1102	
	Yellow	M3SS3-11Y	1SFA 611 212 R1103	
	Blue	M3SS3-11L	1SFA 611 212 R1104	
	Clear	M3SS3-11C	1SFA 611 212 R1108	
Momentary, spring return from A to B				
	Red	M3SS7-11R	1SFA 611 216 R1101	26.00
	Green	M3SS7-11G	1SFA 611 216 R1102	
	Yellow	M3SS7-11Y	1SFA 611 216 R1103	
	Blue	M3SS7-11L	1SFA 611 216 R1104	
	Clear	M3SS7-11C	1SFA 611 216 R1108	
with long handle ①				
Maintained				
	Red	M3SS4-11R	1SFA 611 213 R1101	17.00
	Green	M3SS4-11G	1SFA 611 213 R1102	
	Yellow	M3SS4-11Y	1SFA 611 213 R1103	
	Blue	M3SS4-11L	1SFA 611 213 R1104	
	Clear	M3SS4-11C	1SFA 611 213 R1108	
Momentary, spring return from A to B and from C to B				
	Red	M3SS5-11R	1SFA 611 214 R1101	26.00
	Green	M3SS5-11G	1SFA 611 214 R1102	
	Yellow	M3SS5-11Y	1SFA 611 214 R1103	
	Blue	M3SS5-11L	1SFA 611 214 R1104	
	Clear	M3SS5-11C	1SFA 611 214 R1108	
Momentary, spring return from C to B				
	Red	M3SS6-11R	1SFA 611 215 R1101	26.00
	Green	M3SS6-11G	1SFA 611 215 R1102	
	Yellow	M3SS6-11Y	1SFA 611 215 R1103	
	Blue	M3SS6-11L	1SFA 611 215 R1104	
	Clear	M3SS6-11C	1SFA 611 215 R1108	
Momentary, spring return from A to B				
	Red	M3SS8-11R	1SFA 611 217 R1101	26.00
	Green	M3SS8-11G	1SFA 611 217 R1102	
	Yellow	M3SS8-11Y	1SFA 611 217 R1103	
	Blue	M3SS8-11L	1SFA 611 217 R1104	
	Clear	M3SS8-11C	1SFA 611 217 R1108	

Contact blocks, lamp block and holder See Page 8.13

Contact functions See Page 8.13

Ordering example See Page 8.13

① No contact block in the center position, reserved for lamp block.

Key-operated selector switches 2 and 3 positions

8

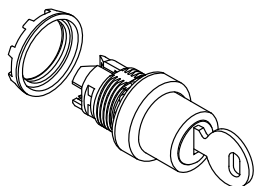
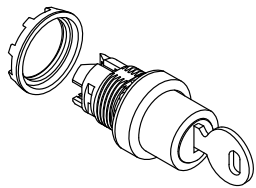

Bezel in black plastic as standard

Bezel in metal:

Replace '1' in the:

Catalog No. MXSSKX-1 0Δ

Ref. Code 1SFA6112XX R 1XXΔ

3 for metal bezel

② Key codes

71 (standard) Δ =1

72 Δ =2

73 Δ =3

Other (on request)

③ Key codes

71 (standard) Δ =1

72 Δ =2

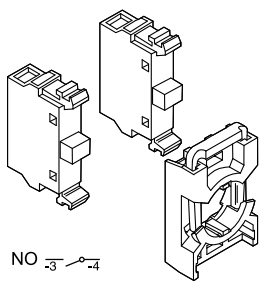

Operator ...

Symbol	The key can be removed in	Catalog No.	Ref. Code	List Price
2 positions ①				
Maintained 	in both positions	M2SSK1-10Δ ①	1SFA 611 280 R100Δ ②	\$ 41
Maintained 	in position B only	M2SSK2-10Δ ①	1SFA 611 281 R100Δ ②	
Momentary, spring return from C to B 	in position B only	M2SSK3-10Δ ①	1SFA 611 282 R100Δ ②	
3 positions ①				
Maintained 	in all positions	M3SSK1-10Δ ①	1SFA 611 283 R100Δ ②	53
Maintained 	in position B only	M3SSK2-10Δ ①	1SFA 611 284 R100Δ ②	
Momentary, spring return from A to B and from C to B 	in position B only	M3SSK3-10Δ ①	1SFA 611 285 R100Δ ②	
Momentary, spring return from C to B 	in position A only	M3SSK4-10Δ ①	1SFA 611 286 R100Δ ③	
Momentary, spring return from C to B 	in all positions	M3SSK5-10Δ ①	1SFA 611 287 R100Δ ②	

Contact blocks and holder

Blocks	Catalog No.	Ref. Code	List Price
2 NO with holder	MCBH-20	1SFA 611 605 R1102	\$ 18.00
2 NC with holder	MCBH-02	1SFA 611 605 R1120	
1 NO + 1 NC with holder	MCBH-11	1SFA 611 605 R1111	
1 NO without holder	MCB-10	1SFA 611 610 R1001	8.00
1 NC without holder	MCB-01	1SFA 611 610 R1010	8.00
Holder for 3 blocks	MCBH-00	1SFA 611 605 R1100	2.00

Contact functions

Two positions: See Page 8.12

Three positions: See Page 8.13

Ordering example

Requested: A key-operated selector switch. Three positions.

Maintained. Key removable in position B. Key code 72.

With 2 NC contacts

Ref.: 1 piece of M3SSK2-102 + 1 piece of MCBH-02

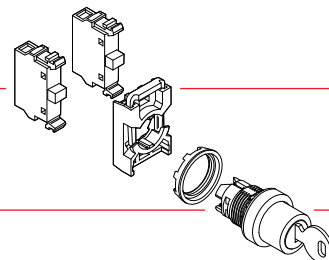

① No contact block in the center position

Toggle switches 2 and 3 positions

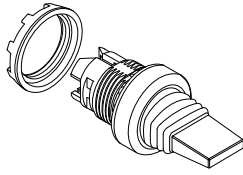

Operator

Symbol	Bezel	Catalog No.	Ref. Code	List Price
--------	-------	-------------	-----------	------------

Toggle switch with 2 positions

Maintained

	Black plastic	MTS1-10B	1SFA 611 300 R1006	\$ 18.00
	Metal	MTS1-30B	1SFA 611 300 R 3006	

Toggle switch with 3 positions

Momentary, spring return from A to B and from C to B

	Black plastic	MTS2-10B	1SFA 611 301 R1006	18.00
	Metal	MTS2-30B	1SFA 611 301 R 3006	

Maintained

	Black plastic	MTS3-10B	1SFA 611 302 R1006	18.00
	Metal	MTS3-30B	1SFA 611 302 R 3006	

Contact blocks and holder

Blocks	Catalog No.	Ref. Code	List Price
1 NO with holder	MCBH-10	1SFA 611 605 R1101	\$ 10.00
1 NC with holder	MCBH-01	1SFA 611 605 R1110	10.00
2 NO with holder	MCBH-20	1SFA 611 605 R1102	18.00
2 NC with holder	MCBH-02	1SFA 611 605 R1120	18.00
1 NO + 1 NC with holder	MCBH-11	1SFA 611 605 R1111	18.00
1 NO without holder	MCB-10	1SFA 611 610 R1001	8.00
1 NC without holder	MCB-01	1SFA 611 610 R1010	8.00
Holder for 3 blocks	MCBH-00	1SFA 611 605 R1100	2.00

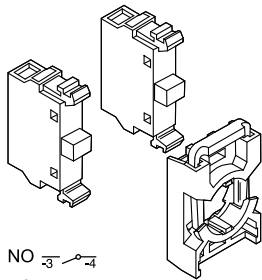

Contact block functions

Block positions as seen from operator front.

Two-position maintained switch

Handle position	Left block	Right block
A	O	O
C	x	x

O = not actuated (normal state)
x = actuated (state changed)

Three-position switch

Handle position	Left block	Middle block	Right block
A	O	x	x
B	O	O	O
C	x	x	O

O = not actuated (normal state)
x = actuated (state changed)

Center position connection detail

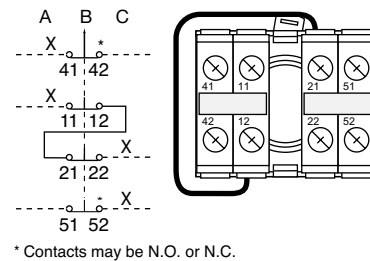
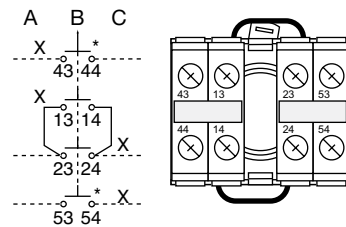

2 position selector switches for mounting in vertically mounted enclosures

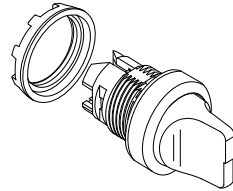
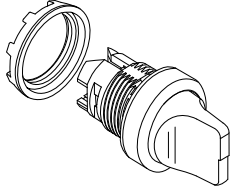

Bezel in black plastic as standard
Bezel in metal:
Replace '1' in the:
Catalog No. M2SSX-1 0X
Ref. Code 1SFA611XXX R 1XXX
3 for metal bezel
4 for grey plastic bezel

Contact functions

Block positions as seen from operator front.

Handle position	Left block	Right block
A (B)	O	O
O	x	x

O = not actuated (normal state)
x = actuated (state changed)

Non-illuminated operator ... ①

Symbol	Handle color	Catalog No.	Ref. Code	List Price
with short handle				
Maintained				
	Red Black	M2SSV1-10R M2SSV1-10B	1SFA 611 220 R1001 1SFA 611 220 R1006	\$ 11.00
Maintained				
	Red Black	M2SSV2-10R M2SSV2-10B	1SFA 611 221 R1001 1SFA 611 221 R1006	11.00
Momentary, spring return from C to B				
	Red Black	M2SSV3-10R M2SSV3-10B	1SFA 611 222 R1001 1SFA 611 222 R1006	14.00

Illuminated operator ... ① ②

Symbol	Handle color	Catalog No.	Ref. Code	List Price
with short handle				
Maintained				
	Red Green Yellow	M2SSV1-11R M2SSV1-11G M2SSV1-11Y	1SFA 611 220 R1101 1SFA 611 220 R1102 1SFA 611 220 R1103	\$ 17.00
Maintained				
	Red Green Yellow	M2SSV2-11R M2SSV2-11G M2SSV2-11Y	1SFA 611 221 R1101 1SFA 611 221 R1102 1SFA 611 221 R1103	17.00
Momentary, spring return from C to B				
	Red Green Yellow	M2SSV3-11R M2SSV3-11G M2SSV3-11Y	1SFA 611 222 R1101 1SFA 611 222 R1102 1SFA 611 222 R1103	26.00

① No contact in center position. Reserved for lamp block.

② Lamp block for max 230 V AC/DC. Bulb not included. Other lamp block see Accessories

3 position selector switches for mounting in vertically mounted enclosures

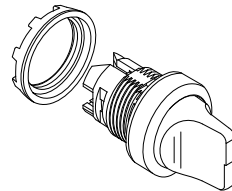
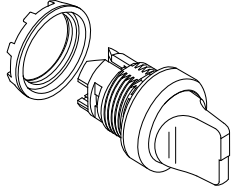

Bezel in black plastic as standard
Bezel in metal:
Replace '1' in the:
Catalog No. M3SSX-1 0X
Ref. Code 1SFA611XXX R 1XXX
3 for metal bezel
4 for grey plastic bezel

Contact functions
Block positions as seen from
operator front.

Handle position	Left block	Right block
A	x	0
B	0	0
C	0	x

Non-illuminated operator ... ①

Symbol	Handle color	Catalog No.	Ref. Code	List Price
with short handle				
Maintained				
	Red Black	M3SSV1-10R M3SSV1-10B	1SFA 611 230 R1001 1SFA 611 230 R1006	\$ 11.00
Momentary, spring return from A to B and from C to B				
	Red Black	M3SSV2-10R M3SSV2-10B	1SFA 611 231 R1001 1SFA 611 231 R1006	14.00
Momentary, spring return from C to B				
	Red Black	M3SSV3-10R M3SSV3-10B	1SFA 611 232 R1001 1SFA 611 232 R1006	14.00

Illuminated operator ... ① ②

Symbol	Handle color	Catalog No.	Ref. Code	List Price
with short handle				
Maintained				
	Red Green Yellow	M3SSV1-11R M3SSV1-11G M3SSV1-11Y	1SFA 611 230 R1101 1SFA 611 230 R1102 1SFA 611 230 R1103	\$ 17.00
Momentary, spring return from A to B and from C to B				
	Red Green Yellow	M3SSV2-11R M3SSV2-11G M3SSV2-11Y	1SFA 611 231 R1101 1SFA 611 231 R1102 1SFA 611 231 R1103	26.00
Momentary, spring return from C to B				
	Red Green Yellow	M3SSV3-11R M3SSV3-11G M3SSV3-11Y	1SFA 611 232 R1001 1SFA 611 232 R1002 1SFA 611 232 R1003	26.00

Contact blocks, lamp block and holder See Page 8.96

① No contact in center position. Reserved for lampblock.

② Lamp block for max 230 V AC/DC. Bulb not included. Other lamp block see Accessories