

## Low Profile IN BOX™ for Retrofit Siding Construction

Recessed electrical box with weatherproof-in-use cover for existing siding construction. Non-metallic cover and base. Accepts most single gang wiring devices and uses standard indoor wall plates or a GFCI cover plate. Box and white cover are textured/paintable. UV rated plastic for long outdoor life.



DBHR131W

CATALOG NUMBER	UPC/DCI/NAED MFG #018997	ORIENTATION/COVER COLOR	SIDING LAP SIZE	UNIT PKG	STD PKG	DIM A	DIM B	DIM C	DIM D	DIM E
DBHR131C	77612	Vertical/Clear	1/4" or 5/16"	1	4	4.934	7.186	5.160	1.567	3.539
DBHR131W	77614	Vertical/White	1/4" or 5/16"	1	4	4.934	7.186	5.160	1.567	3.539
DBHR141C	77616	Horizontal/Clear	1/2"	1	4	4.934	7.186	5.160	1.567	3.539
DBHR141W	77618	Horizontal/White	1/2"	1	4	4.934	7.186	5.160	1.567	3.539
DBHR151C	77620	Vertical/Clear	5/8"	1	4	4.934	7.186	5.160	1.567	3.539
DBHR151W	77622	Vertical/White	5/8"	1	4	4.934	7.186	5.160	1.567	3.539
DBHR171C	77624	Horizontal/Clear	Dutch	1	4	4.934	7.186	5.160	1.567	3.539
DBHR171W	77626	Horizontal/White	Dutch	1	4	4.934	7.186	5.160	1.567	3.539

\*Add suffix "GC" to Catalog # when ordering in Canada, for example DBHR131WGC. Replacement covers available on page K-17.



E170558 LR49636

WEATHERPROOF-IN-USE

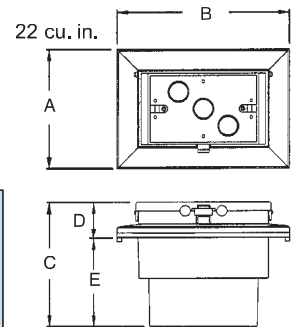

IN BOX for retrofit siding includes...

Box with weatherproof-in-use cover, installed bug plugs, siding profile adapter plate, (1) standard duplex and (1) standard GFCI face plate, (2) sets installation screws, (1) NM cable connector, and (2) rolls of caulk.

### Features and Benefits

- IN BOX's one-piece assembly replaces the installation of an electrical box, siding block, and bubble cover assembly
- Installs in the wall, so less of it shows outside
- Install option: Cover is removable for easier device installation
- No gaskets required

### Siding Profiles

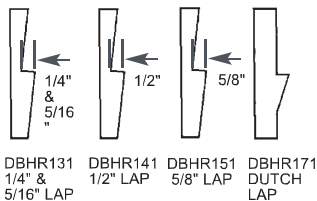

DBHR131 1/4" & 5/16" LAP  
DBHR141 1/2" LAP  
DBHR151 5/8" LAP  
DBHR171 DUTCH LAP



Bug Plugs ship installed in all IN BOX styles to seal unused cord hole openings.

### Installation Instructions for Existing Siding



Using the siding profile adapter plate as a template, cut hole in existing siding. Pull wiring.



Apply caulk around edges of back of adapter (see page J-14, step 2a). Press onto siding. Attach adapter to siding with provided short screws. Trim excess caulk as needed.

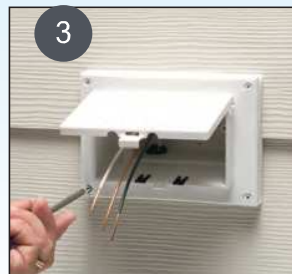

Apply caulk to reverse side of IN BOX flange (see page J-14, step 3a). Install NM cable connector and wire, then attach with provided long screws. Trim excess caulk as needed.

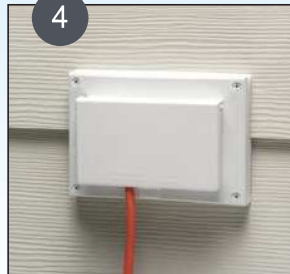

Install wiring device per manufacturer's instructions, Local and National Electrical Codes. Completed installation with weatherproof-in-use cover. DBHR131W shown.

Note: Meets 2011 NEC Section 406-9; for the protection of exterior outlets which require the use of a weatherproof while-in-use cover for all outdoor 15 or 20 AMP receptacles.