

Watertight Hubs

Zinc Die Cast, Insulated and Gasketed

Suitable for use in Class I, Division 2

Applications

- Used to connect rigid metal conduit or IMC to a threadless opening in an enclosure.
- May be used in wet or dry locations, indoors or outdoors.

Features

- Rugged metallic construction ensures mechanical protection.
- Insulated throat, rated up to 105 °C, prevents wire abrasion.
- Integral O-ring provides watertight seal.
- Grounding version provides positive ground for external conductor.
- Unique profile permits easy wrenching.
- Smooth, accurately tapped threads facilitate installation.
- Watertight and corrosion resistant.
- NEMA Types 2, 3, 3R, 4, 4X, 5, 12, 13

Material/Finish

- Bodies and nuts: zinc die cast
- O-ring: BUNA-N
- Insulator: polycarbonate
- Ground screw: mild steel

Certifications and Compliances

- UL Standard: 514B
- UL Listed: E32539
- CSA Standard: C22.2 No. 18.3
- CSA Certified: 065178
- NEMA: FB-1

Options

- PVC coating available on select hubs. Add suffix **-PVC** to catalog number.



HUB



HUBG

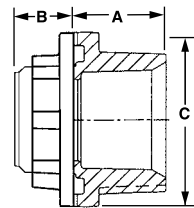

HUB Series

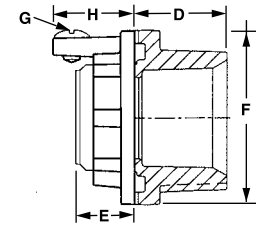

HUBG Series

COMMERCIAL PRODUCTS: RIGID AND IMC FITTINGS

Commercial Products

Hub Spacing

Knockout Hole Size (in./mm.)	Trade Size (Inches)	Trade Size Dimensions in Inches												
		1/2"	3/4"	1"	1-1/4"	1-1/2"	2"	2-1/2"	3"	3-1/2"	4"			
0.88/22.35	1/2	1.56/33.6												
1.13/33.0	3/4	1.69/42.9	1.81/45.9											
1.38/35.1	1	1.84/46.7	1.97/50.0	2.13/54.1										
1.75/44.45	1-1/4	2.03/51.6	2.16/54.9	2.31/58.7	2.50/63.5									
2.00/50.8	1-1/2	2.22/56.4	2.34/59.4	2.50/63.5	2.69/68.3	2.88/73.1								
2.50/63.5	2	2.47/62.7	2.59/65.8	2.75/69.9	2.97/75.4	3.13/79.5	3.38/85.9							
3.00/76.2	2-1/2	2.72/69.1	2.84/72.1	3.00/76.2	3.19/81.0	3.38/85.9	3.63/92.2	3.88/98.6						
3.63/92.2	3	3.01/76.5	3.16/80.3	3.31/84.1	3.50/88.9	3.69/93.7	3.81/96.8	4.49/114.0	4.50/114.3					
4.13/104.9	3-1/2	3.34/84.8	3.47/88.1	3.63/92.2	3.81/96.8	4.00/101.6	4.25/107.9	4.50/114.3	4.81/122.2	5.13/130.3				
4.63/117.6	4	3.59/91.2	4.72/119.9	3.88/98.6	4.06/103.1	4.25/107.9	4.50/114.3	4.75/120.7	5.06/128.5	5.38/136.7	5.75/146.1			

Dimensions in **bold** are for centers of conduits of same size, all other dimensions are for centers of conduits of a different size.

Watertight Hubs

Zinc Die Cast, Insulated and Gasketed

Suitable for use in Class I, Division 2

Zinc Diecast Hubs — Insulated						
Catalog Number	Trade Size (Inches)	Dimensions in Inches/Millimeters		Dimensions in Inches/Millimeters		
		Hole Diameter Min. — Max.	Panel Thickness Min. — Max.	A	B	C
HUB-50DN †	1/2	0.86 — 0.91/ 21.8 — 23.1	0.03 — 0.25/ 0.8 — 6.4	0.84/21.3	0.64/16.3	1.44/36.6
HUB-75DN †	3/4	1.08 — 1.14/ 27.4 — 28.9	0.03 — 0.25/ 0.8 — 6.4	0.94/23.9	0.64/16.3	1.69/42.9
HUB-100DN †	1	1.33 — 1.41/ 33.8 — 35.8	0.03 — 0.25/ 0.8 — 6.4	1.03/26.2	0.78/19.8	2.00/50.8
HUB-125DN †	1-1/4	1.67 — 1.77/ 42.4 — 44.9	0.03 — 0.25/ 0.8 — 6.4	1.12/28.4	0.78/19.8	2.38/60.5
HUB-150DN †	1-1/2	1.92 — 2.02/ 48.8 — 51.3	0.06 — 0.25/ 1.5 — 6.4	1.12/28.4	0.78/19.8	2.75/69.9
HUB-200DN †	2	2.36 — 2.50/ 59.9 — 63.5	0.06 — 0.25/ 1.5 — 6.4	1.12/28.4	0.78/19.8	3.25/82.6
HUB-250DN †	2-1/2	2.86 — 3.00/ 72.6 — 76.2	0.06 — 0.31/ 1.5 — 7.9	1.56/39.6	1.06/26.9	3.72/94.5
HUB-300DN †	3	3.48 — 3.63/ 88.4 — 92.2	0.06 — 0.31/ 1.5 — 7.9	1.56/39.6	1.06/26.9	4.38/111.3
HUB-350DN †	3-1/2	3.98 — 4.16/ 101.1 — 105.7	0.06 — 0.31/ 1.5 — 7.9	1.56/39.6	1.06/26.9	4.94/125.5
HUB-400DN †	4	4.48 — 4.67/ 113.8 — 118.6	0.06 — 0.31/ 1.5 — 7.9	1.56/39.6	1.06/26.9	5.47/138.9

Grounding Style Hubs — Insulated								
Catalog Number	Trade Size (Inches)	Dimensions in Inches/Millimeters		Dimensions in Inches/Millimeters				
		Hole Diameter Min. — Max.	Panel Thickness Min. — Max.	D	E	F	G	H
HUBG-50DN	1/2	0.86 — 0.91/ 21.8 — 23.1	0.03 — 0.25/ 0.8 — 6.4	0.84/21.3	0.64/16.3	1.44/36.6	10—32x1/4	0.69/17.5
HUBG-75DN	3/4	1.08 — 1.14/ 27.4 — 28.9	0.03 — 0.25/ 0.8 — 6.4	0.94/23.9	0.64/16.3	1.69/42.9	10—32x1/4	0.78/19.8
HUBG-100DN	1	1.33 — 1.41/ 33.8 — 35.8	0.03 — 0.25/ 0.8 — 6.4	1.03/26.2	0.78/19.8	2.00/50.8	10—32x1/4	0.78/19.8
HUBG-125DN	1-1/4	1.67 — 1.77/ 42.4 — 44.9	0.03 — 0.25/ 0.8 — 6.4	1.12/28.4	0.78/19.8	2.38/60.5	1/4—20x3/8	0.81/20.6
HUBG-150DN	1-1/2	1.92 — 2.02/ 48.8 — 51.3	0.06 — 0.25/ 1.5 — 6.4	1.12/28.4	0.78/19.8	2.75/69.9	1/4—20x3/8	1.00/25.4
HUBG-200DN	2	2.36 — 2.50/ 59.9 — 63.5	0.06 — 0.25/ 1.5 — 6.4	1.12/28.4	0.78/19.8	3.25/82.6	1/4—20x1/2	1.00/25.4
HUBG-250DN	2-1/2	2.86 — 3.00/ 72.6 — 76.2	0.06 — 0.31/ 1.5 — 7.9	1.56/39.6	1.06/26.9	3.72/94.5	1/4—20x1/2	1.25/31.8
HUBG-300DN	3	3.48 — 3.63/ 88.4 — 92.2	0.06 — 0.31/ 1.5 — 7.9	1.56/39.6	1.06/26.9	4.38/111.3	1/4—20x1/2	1.25/31.8
HUBG-350DN	3-1/2	3.98 — 4.16/ 101.1 — 105.7	0.06 — 0.31/ 1.5 — 7.9	1.56/39.6	1.06/26.9	4.94/125.5	1/4—20x1/2	1.31/33.3
HUBG-400DN	4	4.48 — 4.67/ 113.8 — 118.6	0.06 — 0.31/ 1.5 — 7.9	1.56/39.6	1.06/26.9	5.47/138.9	1/4—20x1/2	1.31/33.3

† PVC coating available on select hubs. Add suffix **-PVC** to catalog number.