

Cable Connectors

For NM • SEU cable.
Zinc die-cast.



CATALOG NUMBER	UPC/DCI/NAED MFG #018997	TRADE SIZE	KO SIZE	UNIT PKG	STD PKG	DIM A	DIM B	DIM C	MAX OPENING
842	00842	3/4	3/4	50	500	.481	1.000	1.375	.730
843	00843	1	1	25	250	.780	1.284	1.670	.850
844	00844	1-1/4	1-1/4	10	100	.710	1.312	2.030	.900
848*	00848	1-1/2	1-1/2	10	50	.817	1.453	2.300	.960
849*	00849	2	2	10	50	.823	1.590	2.900	.960

*UL# E66990 - Service entrance ONLY.

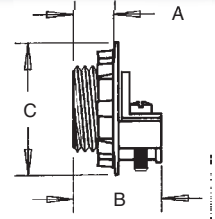

Cable Connectors

For NM • SE cable.
Zinc die-cast.



CATALOG NUMBER	UPC/DCI/NAED MFG #018997	TRADE SIZE	KO SIZE	UNIT PKG	STD PKG	DIM A	DIM B	DIM C	MAX OPENING
842	00842	3/4	3/4	50	500	.481	1.000	1.375	.730
843S	84310	1	1	25	250	.780	1.284	1.670	.970
844S	84410	1-1/4	1-1/4	10	100	.710	1.312	2.030	1.160
848S	84810	1-1/2	1-1/2	10	50	.817	1.453	2.300	1.420
849S	84910	2	2	10	50	.823	1.590	2.900	1.750

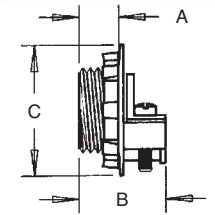

NM Cable Connectors

Plated steel.



CATALOG NUMBER	UPC/DCI/NAED MFG #018997	TRADE SIZE	UNIT PKG	STD PKG	DIM A	DIM B	MAX OPENING
BT50*	24050	14/2 - 8-3	100	1000	1.500	.720	.250 - .600
BT75*	24075	8/2 - 6/2	50	500	1.764	.811	.124 - .934
BT125	24125	2/0 - 3/0	25	250	2.245	.842	.275 - .900
BT150	24150	4/0	20	200	2.705	.835	.275 - .900

*UL only.

Refer to pages C-12 and C-13 for complete cable ranges.

