

MORE
on
reverse

UL/CSA Listed Box Extenders

The answer to set back electrical boxes!



Two-hour fire rating.
Complies with 2008 NEC, Article 314.20.

Our UL and CSA Listed Box Extenders extend set back *metallic or non-metallic* electrical boxes up to 1-1/2".

Made of heavy-duty, non-conductive plastic, they level and support wiring devices. And, they prevent arcing by forming a barrier between a metal box and metal side screws on the device.

Try them *all* for the safe and easy way to obtain UL or CSA Listed installations in set back boxes.

- Single-gang **BE1** and two-gang **BE2** for all standard devices, switches and GFCIs
- **BE1R** for round or octagonal boxes

And NOW, **three- and four-gang box extenders!**

NEW Sizes!

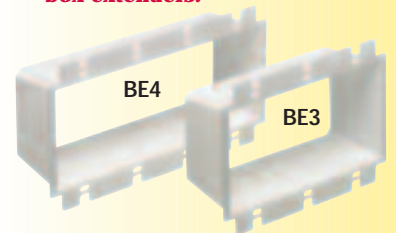

- **BE3** and **BE4** for great-looking installations in set back multiple gang boxes

Arlington's box extenders meet 2008 NEC, article 314.20 and deliver a two-hour fire rating.



1 Stauffer Industrial Park
Scranton, PA 18517
800/233.4717
Fax 570/562.0646
www.aifittings.com

Catalog Number	UPC/DEI/NAED Mfg. #018997	Description Box Extenders	For Box Size	Std Pkg
BE1	40160	Plastic. Non-combustible. For extending set back metal or plastic boxes up to 1-1/2"	Single gang	25
BE2	48960		Two-gang	25
BE3	48967		Three-gang	10
BE4	48968		Four-gang	10
BE1R	40160	Round box extender for set back ceiling boxes	3-1/2" and 4" round or octagonal, metal or plastic	25

UL/CSA Listed Box Extenders

Extend set back metal or non-metallic boxes up to 1-1/2"

Our new BE3 and BE4 are the easiest box extenders to use for three- and four-gang installations. But, if you're ever caught short, the flanges of the single-gang BE1 are trimmable for use in multiple gang boxes.



DO NOT cut the flanges off the outside (left and right) box extenders (see below).

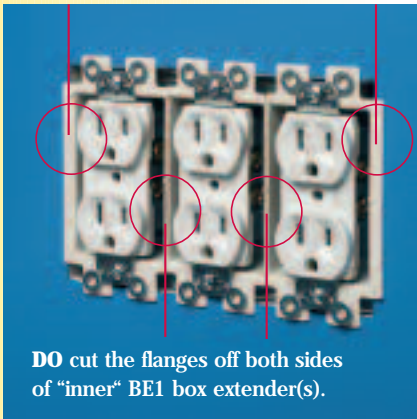

1 Stauffer Industrial Park
Scranton, PA 18517
800/233.4717
Fax 570/562.0646
www.aifittings.com

BE1 ETC 0908/30M

Fast and easy installation – And the remedy for set back boxes.

BE1 installation

PROBLEM...

Electrical box is set back from wall surface.



SOLUTION...



1 Pull wires through, then press the BE1 firmly into the electrical box.

To install without removing the device wires, tilt the device through the BE1 at a slight angle, straighten it and tighten the screws!

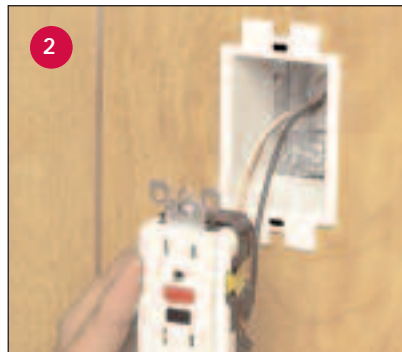

2 Attach wires to receptacle. Then tighten screws for a level, fully supported, code compliant installation.

BE1R installation

PROBLEM...

Ceiling box is set back from surface.

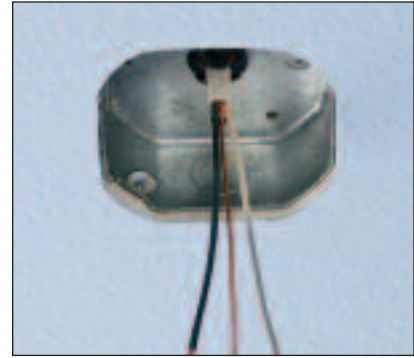

SOLUTION...

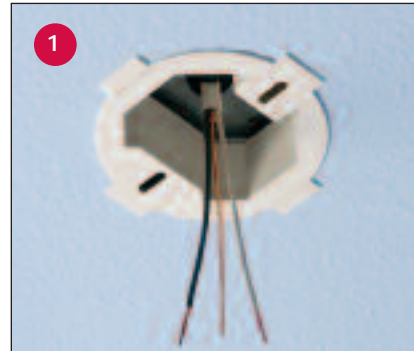

1 Non-conductive BE1R Box Extender installs easily and extends box flush with ceiling surface.

2 Install fixture.

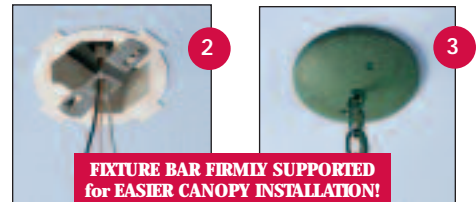

3 Completed installation...level and code compliant!

Distributed by