

# Type 4X Enclosures

## Type 4X Stainless Steel JIC Continuous Hinge Cover Enclosures Data Sheet

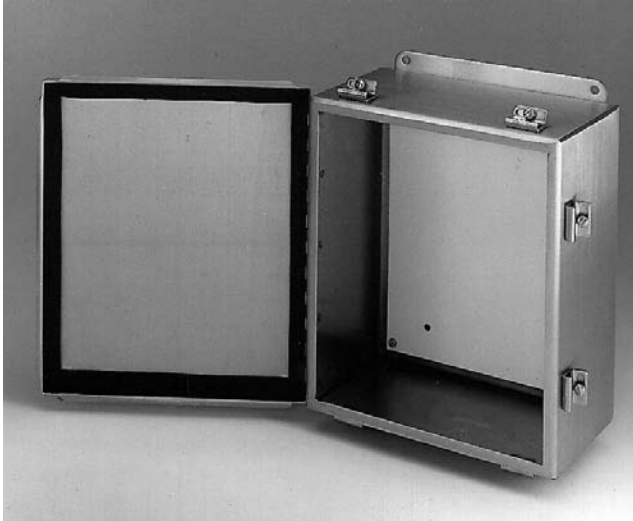

### Application

- Houses electrical controls and instruments
- Intended for indoor or outdoor use where a corrosive environment exists
- Protects against corrosion, windblown dust and rain, splashing water and hose directed water

### Standards

- UL 508 listed, Type 4X, Type 4, Type 13 and Type 12
- CSA C22.2 No.94 certified, Type 4X, Type 4, Type 13 and Type 12
- Conforms to NEMA standard for Type 4X, Type 4, Type 13 and Type 12
- Conforms to JIC standard EGP-1-1967
- IEC 60529, IP66

### Construction

- Enclosure and cover are fabricated from (16) gauge, Type 304 or Type 316L stainless steel
- All continuous welded seams are finished smooth
- Cover is secured to the body with a stainless steel continuous hinge and pin on one side and easy-to-operate stainless steel screw clamps mounted to the opposite side
- Cover has a fixed, oil and water-resistant gasket
- Ground stud provided on cover
- #10-32 weldnuts are provided for mounting optional panel
- External mounting feet are provided for secure wall mounting

### Finish

- Outer surface of enclosure and cover has a smooth brushed finish

### Accessories

- Panels
- JIC terminal strap kit
- JIC terminal strip kit
- Terminal blocks
- See Accessories section

# Type 4X Enclosures

## Type 4X Stainless Steel JIC Continuous Hinge Cover Enclosures Catalog Number

Enclosure Catalog Number		Enclosure Size		D		E		F		Panel Catalog Number		Panel Size	
Stainless Steel		Height x Width x Depth										Height x Width	
Type 304	Type 316L	in.	mm	in.	mm	in.	mm	in.	mm	Steel	Stainless	in.	mm
644-4XSCHC	644-4XSS6CHC	6.00x4.00x4.00	152x102x102	3.00	76	-	-	2.00	51	AW64P	AW64SP	4.87x2.87	124x73
664-4XSCHC	664-4XSS6CHC	6.00x6.00x4.00	152x152x102	3.00	76	-	-	3.00	76	AW66P	AW66SP	4.87x4.87	124x124
864-4XSCHC	864-4XSS6CHC	8.00x6.00x4.00	203x152x102	4.00	102	-	-	3.00	76	AW86P	AW86SP	6.87x4.87	174x124
884-4XSCHC	884-4XSS6CHC	8.00x8.00x4.00	203x203x102	4.00	102	-	-	4.00	102	AW88P	AW88SP	6.87x6.87	174x174
1084-4XSCHC	1084-4XSS6CHC	10.00x8.00x4.00	254x203x102	2.00	51	-	-	4.00	102	AW108P	AW108SP	8.87x6.87	225x174
12106-4XSCHC	12106-4XSS6CHC	12.00x10.00x6.00	305x254x152	3.00	76	-	-	2.00	51	AW1210P	AW1210SP	10.87x8.87	276x225
12126-4XSCHC	12126-4XSS6CHC	12.00x12.00x6.00	305x305x152	3.00	76	-	-	3.00	76	AW1212P	AW1212SP	10.87x10.87	276x276
14126-4XSCHC	14126-4XSS6CHC	14.00x12.00x6.00	356x305x152	3.00	76	-	-	3.00	76	AW1412P	AW1412SP	12.87x10.87	327x276
16146-4XSCHC	16146-4XSS6CHC	16.00x14.00x6.00	406x356x152	2.00	51	8.00	203	3.00	76	AW1614P	AW1614SP	14.87x12.87	376x327

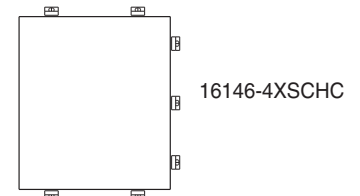
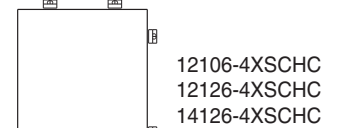
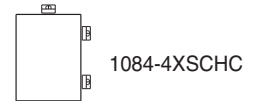
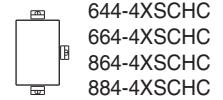

Type 4X Enclosures

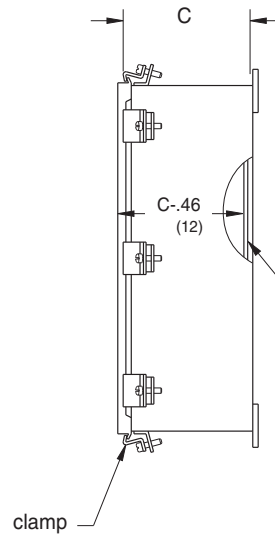
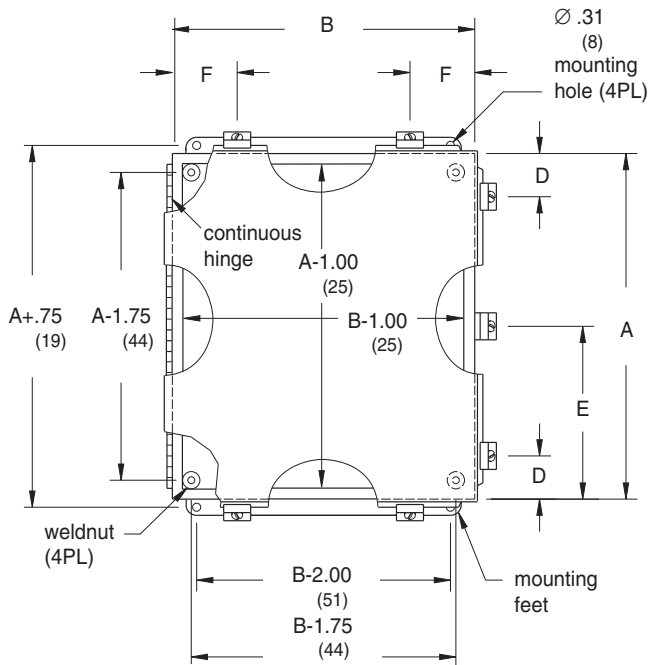

Cover Clamp Layout

Notes: Dimensions are in inches. Millimeters shown are for reference only. Data subject to change without notice.