

# SEALING FITTINGS

## Sealing Fittings - 25% Fill

### FEATURES

- Sealing Fittings are required in Hazardous Locations and are used to isolate arc-producing devices in conduit and wiring systems, and to prevent the passage of explosive pressures from one area to another.
- FOR HORIZONTAL AND VERTICAL MOUNTING - Type XYB and XYBM are suitable for either horizontal or vertical mounting and are provided with threaded plugged openings into which fiber and cement can be placed to form effective seal. XYB has female ends for conduit entrance. The XYBM has female ends with a removable threaded nipple.



**XYB-XYBM**

EXPLOSIONPROOF  
Fittings & Accessories

FEMALE - FEMALE					
Catalog #	Conduit Size (in.)	Oz. Req. for Ea. Sealing Fitting		Std. Package	
		Sealing Cement	Packing Fiber	Qty.	Weight lbs.
XYB-2	1/2	1	1/8	5	2.1
XYB-3	3/4	2	1/4	5	2.6
XYB-4	1	3	1/4	5	3.7
XYB-5	1 1/4	6	3/8	2	2.5
XYB-6	1 1/2	9	1/2	2	3.2
XYB-8	2	18	3/4	2	5.6
XYB-10	2 1/2	23	1 1/2	2	6.2
XYB-12	3	48	3 1/8	1	6.0
XYB-14	3 1/2	70	4 1/2	1	6.8
XYB-16	4	90	6	1	8.3

MALE - FEMALE					
Catalog #	Conduit Size (in.)	Oz. Req. for Ea. Sealing Fitting		Std. Package	
		Sealing Cement	Packing Fiber	Qty.	Weight lbs.
XYBM-2	1/2	1	1/8	5	2.2
XYBM-3	3/4	2	1/4	5	2.7
XYBM-4	1	3	1/4	5	3.8
XYBM-5	1 1/4	6	3/8	2	2.6
XYBM-6	1 1/2	9	1/2	2	3.4
XYBM-8	2	18	3/4	2	5.9
XYBM-10	2 1/2	23	1 1/2	2	6.8
XYBM-12	3	48	3 1/8	1	6.3
XYBM-14	3 1/2	70	4 1/2	1	7.3
XYBM-16	4	90	6	1	8.8

NOMINAL DIMENSIONS [inches]					
Conduit Size	A	B	C	D (XYBM)	R (Turn Rad.)
1/2	3 19/32	1 13/16	5/8	11/16	1 3/16
3/4	3 25/32	2 1/16	3/4	15/16	1 5/16
1	4 3/8	2 5/16	7/8	15/16	1 7/16
1 1/4	5 5/32	2 13/16	1 1/16	1 1/16	1 3/4
1 1/2	5 11/16	3 3/16	1 3/16	1 3/16	2
2	6 13/16	3 7/8	1 1/2	1 7/16	2 3/8
2 1/2	7 1/2	4 1/2	1 7/8	1 5/8	2 11/16
3	9 9/16	5 1/2	2 3/16	1 7/8	3 3/16
3 1/2	9 1/2	6 1/8	2 3/8	2	3 11/16
4	9 9/16	6 1/2	2 5/8	2 1/8	3 7/8

\*1/2", 3/4", 1" sizes Class I, Group B, C, D, Class II, E, F, G.

1 1/4", 1 1/2", 2", 2 1/2", 3", 3 1/2", 4" sizes Class I, Group C, D; Class II, E, F, G

### Certifications

Class I, Groups B\*, C & D

Class II, Groups E, F & G

UL Standard 886

CSA Standard C22.2 No. 30



# SEALING FITTINGS

## Sealing Fittings - 40% Fill



**XYB-XYBM**

**FEATURES**

- Sealing Fittings are used for the same application as the standard Adalet sealing fitting but allow up to 40% wire fill in the fitting.

EXPLOSIONPROOF  
Fittings & Accessories

NOMINAL DIMENSIONS [inches]					
Conduit Size	A	B	C	D (XYBM)	R (Turn Rad.)
1/2	3 25/32	2 1/16	3/4	1 5/16	1 5/16
3/4	4 3/8	2 5/16	7/8	1 5/16	1 7/16
1	5 5/32	2 13/16	1 1/16	1 1/16	1 3/4
1 1/4	6 13/16	3 7/8	1 1/2	1 7/16	2 3/8
1 1/2	7 1/2	4 1/2	1 7/8	1 5/8	2 11/16
2	9 9/16	5 1/2	2 3/16	1 7/8	3 5/16
2 1/2	9 1/2	6 1/16	2 3/8	2	3 11/16
3	9 9/16	6 1/2	2 3/8	2 1/8	3 7/8

\*1/2", 3/4" sizes Class I, Group B, C, D, Class II, E, F, G.

1", 1 1/4", 1 1/2", 2", 2 1/2", 3" sizes Class I, Group C, D; Class II, E, F, G

FEMALE - FEMALE					
Catalog #	Conduit Size (in.)	Oz. Req. for Ea. Sealing Fitting		Std. Package	
		Sealing Cement	Packing Fiber	Qty.	Weight lbs.
XYB-34	1/2	2	1/4	5	2.6
XYB-44	3/4	3	1/4	5	3.7
XYB-54	1	6	3/8	2	2.5
XYB-84	1 1/4	18	3/4	2	5.6
XYB-104	1 1/2	23	1 1/2	2	6.2
XYB-124	2	48	3 1/8	1	6.0
XYB-144	2 1/2	70	4 1/2	1	6.8
XYB-164	3	90	6	1	8.3

MALE - FEMALE					
Catalog #	Conduit Size (in.)	Oz. Req. for Ea. Sealing Fitting		Std. Package	
		Sealing Cement	Packing Fiber	Qty.	Weight lbs.
XYBM-34	1/2	2	1/4	5	2.7
XYBM-44	3/4	3	1/4	5	3.8
XYBM-54	1	6	3/8	2	2.6
XYBM-84	1-1/4	18	3/4	2	5.9
XYBM-104	1-1/2	23	1-1/2	2	6.8
XYBM-124	2	48	3-1/8	1	6.3
XYBM-144	2-1/2	70	4-1/2	1	7.3
XYBM-164	3	90	6	1	8.8

**Certifications**

Class I, Groups B\*, C & D  
 Class II, Groups E, F & G  
 UL Standard 886  
 CSA Standard C22.2 No. 30



# SEALING FITTINGS

## Sealing Fittings - 25% Fill

### FEATURES

- Types XY and XYM Fittings: provided with threaded plugged openings into which the sealing cement is poured. Sizes 1-1/4" x 1-1/2" have large plugged openings in the lower hub to facilitate packing fiber around the wires to form a dam. Type XYM's have removable threaded nipples. The two hubs are tapped simultaneously to assure alignment of the conduits, especially important to equipment manufacturers using short runs of conduit.
- FOR HORIZONTAL AND VERTICAL MOUNTING Type XYC Fittings: are for horizontal mounting only, with the cover opening in an upright position. XYCS fittings are for vertical or horizontal mounting, with removable threaded covers which can be turned to the desired Position for pouring in the sealing cement. The covers are interchangeable. The male-to-female types have removable threaded nipple.



**XY 2-3-4**



**XYM 2-3-4**



**XY 5-6**



**XYM 5-6**



**XYC**



**XYCM**



**XYCS**



**XYCSM**

Catalog #		Conduit Size	Oz. Req. for Ea. Sealing Fitting		Std. Package	
Fem- Fem	Male - Fem		Sealing Cement	Packing Fiber	Qty.	Weight lbs.
XY2	XYM2	1/2	1	1/8	25	10
XY3	XYM3	3/4	1	1/4	25	10
XY4	XYM4	1	2	1/4	25	12 1/2
XY5	XYM5	1 1/4	4	3/8	10	7 1/2
XY6	XYM6	1 1/2	5	1/2	10	10
XYC2	XYC2M	1/2	2	1/8	25	13
XYC3	XYC3M	3/4	2	1/4	25	13
XYC4	XYC4M	1	4 1/2	1/4	25	15
XYC5	XYC5M	1 1/4	8 1/2	3/8	10	10
XYC6	XYC6M	1 1/2	11 1/2	1/2	10	11
XYC8	XYC8M	2	13 1/2	3/4	10	12
XYC10	XYC10M	2 1/2	15	1 1/2	1	2
XYC12	XYC12M	3	31 1/2	3 1/8	1	3
XYC14	XYC14M	3 1/2	42 1/2	4 1/2	1	4
XYC16	XYC16M	4	51	6	1	5
XYC25	XYC25M	1/2	2	1/8	25	13
XYC35	XYC35M	3/4	2	1/4	25	13
XYC45	XYC45M	1	3	1/4	25	15
XYC55	XYC55M	1 1/4	6 1/2	3/8	10	10
XYC65	XYC65M	1 1/2	10	1/2	10	11
XYC85	XYC85M	2	12 1/2	3/4	10	12
XYC105	XYC105M	2 1/2	13 1/2	1 1/2	1	2
XYC125	XYC125M	3	29 1/2	3 1/8	1	3
XYC145	XYC145M	3 1/2	40	4 1/2	1	4
XYC165	XYC165M	4	48 1/2	6	1	5

### Certifications

Class I, Group D  
 Class II, Groups E, F & G  
 UL Standard 886  
 CSA Standard C22.2 No. 30



# SEALING FITTINGS

## Sealing Fittings - 40% Fill



**XY 34, 44**



**XYM 34, 44**



**XY 54**



**XYM 54**



**XYC 34-164**



**XYC 34M-164M**



**XYC 34S-164S**



**XYC 34SM-164SM**

**FEATURES**

- Adalet 40% Fill Sealing Fittings are used for the same applications as the standard Adalet Sealing Fittings, but allow up to 40% wire fill in the fitting.

Catalog #		Conduit Size	Oz. Req. for Ea. Sealing Fitting		Std. Package	
Fem- Fem	Male - Fem		Sealing Cement	Packing Fiber	Qty.	Weight lbs.
XY34	XYM34	1/2	1	1/4	25	10
XY44	XYM44	3/4	2	1/4	25	12 1/2
XY54	XYM54	1	4	3/8	10	7 1/2
XYC34	XYC34M	1/2	2	1/4	25	13
XYC44	XYC44M	3/4	4 1/2	1/4	25	15
XYC54	XYC54M	1	8 1/2	3/8	10	10
XYC84	XYC84M	1 1/4	13 1/2	3/4	10	12
XYC104	XYC104M	1 1/2	15	1 1/2	1	2
XYC124	XYC124M	2	31 1/2	3 1/8	1	3
XYC144	XYC144M	2 1/2	42 1/2	4 1/2	1	4
XYC164	XYC164M	3	51	6	1	5
XYC34S	XYC34SM	1/2	2	1/4	25	13
XYC44S	XYC44SM	3/4	3	1/4	25	15
XYC54S	XYC54SM	1	6 1/2	3/8	10	10
XYC84S	XYC84SM	1 1/4	12 1/2	3/4	10	12
XYC104S	XYC104SM	1 1/2	13 1/2	1 1/2	1	2
XYC124S	XYC124SM	2	29 1/2	3 1/8	1	3
XYC144S	XYC144SM	2 1/2	40	4 1/2	1	4
XYC164S	XYC164SM	3	48 1/2	6	1	5

**Certifications**

Class I, Groups B\*, C & D  
 Class II, Groups E, F & G  
 UL Standard 886  
 CSA Standard C22.2 No. 30



EXPLOSIONPROOF  
Fittings & Accessories

# SEALING FITTINGS

## Sealing Fittings - 25% Fill

EXPLOSIONPROOF  
Fittings & Accessories

Catalog #		Conduit Size	Nominal Dimensions					R=Turning Radius Cover		
Fem- Fem	Male - Fem		A	B	C	D	E	Plain	Sealing	None
XY2	XYM2	1/2	3 1/16	2 7/16	3/4	1 1/16				1 13/16
XY3	XYM3	3/4	3 1/16	2 7/16	3/4	1				1 13/16
XY4	XYM4	1	3 3/4	2 15/16	15/16	15/16				2 1/8
XY5	XYM5	1 1/4	4 15/16	3 3/16	1 3/16	1 1/8				2 1/8
XY6	XYM6	1 1/2	4 7/8	3 7/16	1 5/16	1 5/16				2 1/4
XYC2	XYC2M	1/2	3 1/16	2 9/16	2 1/16	5/8	13/16	1 7/8		
XYC2S	XYC2SM	1/2	3 1/16	2 9/16	2 1/16	5/8	13/16		2 11/16	
XYC3	XYC3M	3/4	3 1/16	2 9/16	2 1/16	15/16	13/16	1 7/8		
XYC3S	XYC3SM	3/4	3 1/16	2 9/16	2 1/16	15/16	13/16		2 11/16	
XYC4	XYC4M	1	3 11/16	2 11/16	2 3/8	15/16	1	2 1/8		
XYC4S	XYC4SM	1	4 1/2	3 3/16	3 3/8	1 1/16	7/8		3 1/16	
XYC5	XYC5M	1 1/4	4 1/2	3 3/16	3 3/8	1 1/16	7/8	2 11/16		
XYC5S	XYC5SM	1 1/4	4 1/2	3 3/16	3 3/8	1 1/16	7/8		3 1/16	
XYC6	XYC6M	1 1/2	4 1/2	3 7/16	3 3/8	1 1/8	7/8	2 11/16		
XYC6S	XYC6SM	1 1/2	4 1/2	3 7/16	3 3/8	1 1/8	7/8		3 1/16	
XYC8	XYC8M	2	4 11/16	4	3 3/8	1 3/8	7/8	3		
XYC8S	XYC8SM	2	4 11/16	4	3 3/8	1 3/8	7/8		3 5/16	
XYC10	XYC10M	2 1/2	5 5/16	4 5/8	3 3/8	1 5/8	7/8	3 1/4		
XYC10S	XYC10SM	2 1/2	5 5/16	4 5/8	3 3/8	1 5/8	7/8		3 3/4	
XYC12	XYC12M	3	6 7/16	5 7/16	3 15/16	1 3/4	1 3/8	4		
XYC12S	XYC12SM	3	6 7/16	5 7/16	3 15/16	1 3/4	1 3/8		4 5/8	
XYC14	XYC14M	3 1/2	6 9/16	6 3/8	4 3/4	1 5/8	1 5/16	4 5/8		
XYC14S	XYC14SM	3 1/2	6 9/16	6 3/8	4 3/4	1 5/8	1 5/16		5	
XYC16	XYC16M	4	6 15/16	6 13/16	4 3/4	2	1 5/16	4 3/4		
XYC16S	XYC16SM	4	6 15/16	6 13/16	4 3/4	2	1 5/16		5 3/8	

**XYM**

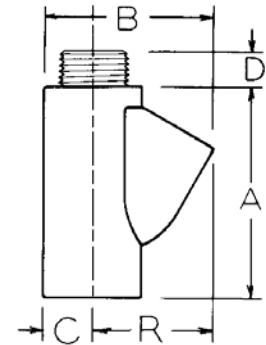

**XYCSM**

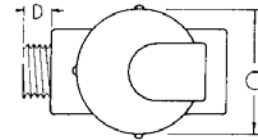

**XYCS**

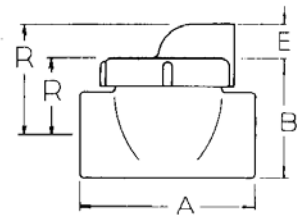

### Certifications

CSA Certified LR27991  
UL Listed E10493



# SEALING FITTINGS

## Sealing Fittings - 40% Fill

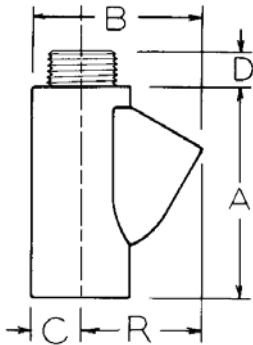

**XYM**

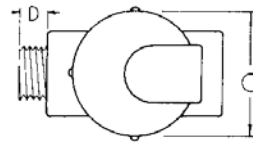

**XYGSM**

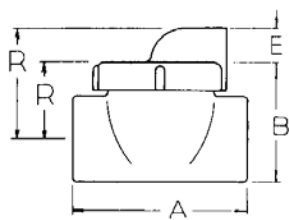

**XYGS**

Catalog #		Conduit Size	Nominal Dimensions					R=Turning Radius Cover		
Fem- Fem	Male - Fem		A	B	C	D	E	Plain	Sealing	None
XY34	XYM34	1/2	3 1/8	2 7/16	3/4	1				1 13/16
XY44	XYM44	3/4	3 3/4	2 15/16	15/16	1 1/16				3 1/8
XY54	XYM54	1	4 15/16	3 3/8	1 3/8	1 1/8				2 1/8
XYC34	XYC34M	1/2	3 1/8	2 9/16	2 1/16	15/16	13/16	1 7/8		
XYC34S	XYC34SM	1/2	3 1/8	2 9/16	2 1/16	15/16	13/16		2 1/16	
XYC44	XYC44M	3/4	3 11/16	2 11/16	2 3/8	15/16	1	2 1/8		
XYC44S	XYC44SM	3/4	3 11/16	2 11/16	2 3/8	15/16	1		3 1/16	
XYC54	XYC54M	1	4 1/2	3 3/8	3 3/8	1 1/16	7/8	2 11/16		
XYC54S	XYC54SM	1	4 1/2	3 3/8	3 3/8	1 1/16	7/8		3 1/16	
XYC84	XYC84M	1 1/4	4 11/16	4	3 3/8	1 3/8	7/8	3		
XYC84S	XYC84SM	1 1/4	4 11/16	4	3 3/8	1 3/8	7/8		3 5/16	
XYC104	XYC104M	1 1/2	5 5/16	4 5/8	3 3/8	1 5/8	7/8	3 1/4		
XYC104S	XYC104SM	1 1/2	5 5/16	4 5/8	3 3/8	1 5/8	7/8		3 3/4	
XYC124	XYC124M	2	6 7/16	5 7/16	3 15/16	1 3/4	1 3/8	4		
XYC124S	XYC124SM	2	6 7/16	5 7/16	3 15/16	1 3/4	1 3/8		4 5/8	
XYC144	XYC144M	2 1/2	6 9/16	6 3/8	4 3/4	1 5/8	1 5/16	4 5/8		
XYC144S	XYC144SM	2 1/2	6 9/16	6 3/8	4 3/4	1 5/8	1 5/16		5	
XYC164	XYC164M	3	6 15/16	6 13/16	4 3/4	2	1 5/16	4 3/4		
XYC164S	XYC164SM	3	6 15/16	6 13/16	4 3/4	2	1 5/16		5 3/8	

EXPLOSIONPROOF  
Fittings & Accessories

**Certifications**

CSA Certified LR27991  
UL Listed E10493

