

Zinc Cable & Conduit Connectors

For Armored Cable, Flexible Metal Conduit & Metal Clad Cable

Type AC

90° 2- Screw Clamp

Use:

To make a 90° termination of conduit or cable to a knockout or unthreaded slip hole in a dry location box or enclosure.

Features:

- Male hub threads NPS
- All center stopped
- Furnished with locknuts
- Available with insulated throat
- Combination head screws on AC(I)-90 through AC(I)-96

Material/Finish:

Zinc Die Cast Body
Zinc Plated Steel Cover

Third Party Certification:



UL Listed: E32539



CSA Certified: 014489

Applicable Third Party Standards:

UL Standard: 514B
CSA Standard: C22.2 No. 18
NEMA: FB-1
Fed. Spec: W-F-406D,
Type I, Class I, Style D, Kind C

Note:

AC-90 through AC-400-D listed for use with regular and reduced wall steel and aluminum flexible metal conduit.

AC-90 and ACI-90 listed for use with 14-2 AWG (nominal O.D. 0.460") to 10-3 AWG (nominal O.D. 0.575") steel armored cable (AC); 14-2 AWG (nominal O.D. 0.480") to 10-3 AWG (nominal O.D. 0.600") aluminum armored cable (AC); 14-2 AWG (nominal O.D. 0.469") to 10-3 AWG (nominal O.D. 0.600") steel interlocking metal-clad cable (MCI); 14-2 AWG (nominal O.D. 0.470") to 10-3 AWG (nominal O.D. 0.610") aluminum interlocking metal-clad cable (MCI); 10-2 AWG (nominal O.D. 0.445") to 10-4 AWG (nominal O.D. 0.538") aluminum interlocking metal-clad cable, grounding type (MCI-A).

AC-95 and ACI-95 listed for use with 8-2 AWG (nominal O.D. 0.660") to 8-3 AWG (nominal O.D. 0.760") steel armored cable (AC); 8-2 AWG (nominal O.D. 0.695") to 8-3 AWG (nominal O.D. 0.785") aluminum armored cable (AC); 8-2 AWG (nominal O.D. 0.675") to 8-3 AWG (nominal O.D. 0.755") steel interlocking metal-clad cable (MCI); 8-2 AWG (nominal O.D. 0.680") to 8-3 AWG (nominal O.D. 0.775") aluminum interlocking metal-clad cable (MCI).

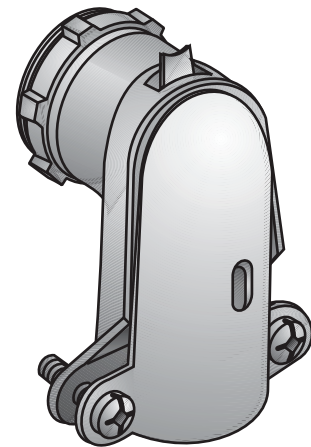
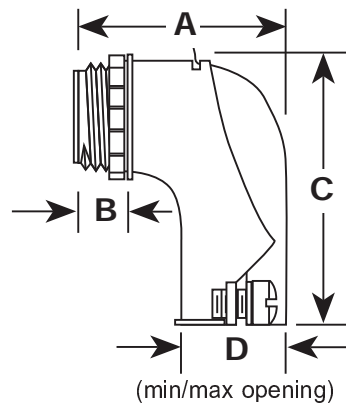

Type AC-90

Trade Size (inches)	Catalog Number	Insulated Throat Catalog Number	Dimensions in Inches			
			A	B	C	D
3/8*	AC-90	ACI-90	1.12	0.48	1.78	0.45-0.78
1/2	AC-95	ACI-95	1.51	0.42	2.12	0.70-1.15
3/4	AC-96	ACI-96	1.70	0.44	2.09	0.98-1.40
1	AC-97		2.33	0.54	2.87	1.09-1.73
1 1/4	AC-98		2.75	0.64	4.00	1.34-1.97
1 1/2	AC-985		3.75	0.75	6.00	1.65-2.61
2	AC-99		4.00	0.74	6.00	1.54-2.54
2 1/2	AC-250-D		6.12	0.87	7.19	2.45-2.98
3	AC-300-D		6.70	1.03	7.87	2.93-3.45
3 1/2	AC-350-D		7.50	1.03	9.40	3.28-3.95
4	AC-400-D		8.70	1.03	10.2	3.68-4.42

* 3/8" fits 1/2" K.O.

Zinc Cable & Conduit Connectors

For Armored Cable, Flexible Metal Conduit & Metal Clad Cable

Type DC- 5500

Duplex Single Screw, Clamp Type

Use:

To make a termination of flexible metal conduit to a knockout or unthreaded slip hole in a dry location box or enclosure.

Features:

- Furnished with locknuts
- Male hub NPS
- Combination head screw

Material/Finish:

Zinc Die Cast

Third Party Certification:

 UL Listed: E25014

 CSA Certified: 014489

Applicable Third Party Standards:

UL Standard: 514B
CSA Standard: C22.2 No. 18
NEMA: FB-1
Fed. Spec: W-F-406D,
Type 1, Class 1, Style B, Kind D

Trade Size (inches)	Catalog Number	Dimensions in Inches		
		A	B	C
3/8"	DC-5500	1.50	0.43	0.85

* 3/8" fits 1/2" K.O.

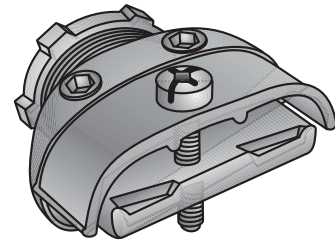
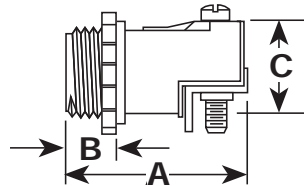

Type DC-5500

Note:

DC-5500 listed for use with 3/8" regular and reduced wall steel and aluminum flexible metal conduit.

DC-5500 listed for use with 14-2 AWG (nominal O.D. 0.460") to 10-3 AWG (nominal O.D. 0.500") steel armored cable (AC); 14-2 AWG (nominal O.D. 0.480") to 10-2 AWG (nominal O.D. 0.580") aluminum armored cable (AC); 14-2 AWG (nominal O.D. 0.470") to 10-3 AWG (nominal O.D. 0.600") steel interlocking metal-clad cable (MCI); 14-2 AWG (nominal O.D. 0.468") to 10-3 AWG (nominal O.D. 0.610") aluminum interlocking metal-clad cable (MCI); 14-2 AWG (nominal O.D. 0.370") to 10-3 AWG (nominal O.D. 0.495") aluminum interlocking metal-clad cable, grounding type (MCI-A).

Type C- 510

2- Screw Connectors

Use:

To terminate regular wall steel or aluminum flexible conduit to a 1/2" knockout in a dry box or enclosure.

Features:

- End stopped
- Male hub threads NPS
- Provided with locknut
- Combination head screw

Material/Finish:

Zinc Die Cast

Third Party Certification:

 UL Listed: E25014

 CSA Certified: 014489

Applicable Third Party Standards:

UL Standard: 514B
CSA Standard: C22.2 No. 18
NEMA: FB-1
Fed. Spec: W-F-406D,
Type 1, Class 1, Style B, Kind D.

Trade Size (inches)	Catalog Number	Dimensions in Inches		
		A	B	C
3/8"	C-510	0.37	0.87	0.91

* 3/8" fits 1/2" K.O.

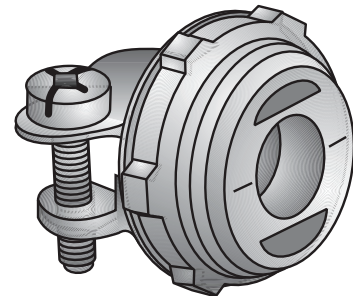
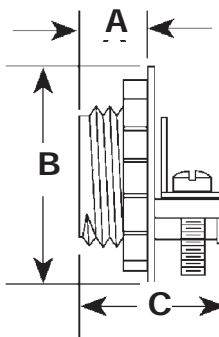

Type C-510

Note:

C-510 listed for use with 3/8" regular and reduced wall steel and aluminum flexible metal conduit.

C-510 listed for use with 14-2 AWG (nominal O.D. 0.460") to 10-2 AWG (nominal O.D. 0.598") steel armored cable (AC); 14-2 AWG (nominal O.D. 0.480") to 10-2 AWG (nominal O.D. 0.565") aluminum armored cable (AC); 14-2 AWG (nominal O.D. 0.469") to 10-3 AWG (nominal O.D. 0.600") steel interlocking metal-clad cable (MCI); 14-2 AWG (nominal O.D. 0.470") to 10-3 AWG (nominal O.D. 0.610") aluminum interlocking metal-clad cable (MCI); 14-2 AWG (nominal O.D. 0.370") to 10-3 AWG (nominal O.D. 0.495") aluminum interlocking metal-clad cable, grounding type (MCI-A).