

THIS COPY IS PROVIDED ON A RESTRICTED BASIS AND IS NOT TO BE USED IN ANY WAY DETRIMENTAL TO THE INTERESTS OF PANDUIT CORP.

PANDUIT PART #	STUD SIZE		DIMENSIONS in. [mm]					TOOLS
	ENGLISH	METRIC	L ± .03 [0,76]	W ± .01 [0,25]	C ± .02 [0,51]	M ± .03 [0,76]	H ± .01 [0,25]	
EV14-6FB	#6	M3	.84 [21,3]	.28 [7,11]	.19 [4,83]	.70 [17,8]	.15 [3,81]	CT-100A *CT-160 *CT-260 *CT-400 CT-600-A (CT-500CH) CT-600-A (CT-550CH) CT-1550 CT-1551 CT-2500 (CT-2550CH)
EV14-8FB	#8	M4	.90 [22,9]	.31 [7,87]	.23 [5,84]	.74 [18,8]	.17 [4,32]	
EV14-10FB	#10	M5	.92 [23,4]	.34 [8,64]	.24 [6,10]	.76 [19,3]	.20 [5,08]	

*PANDUIT APPROVED TOOL

NOTES:

- UL LISTED AND CSA CERTIFIED FOR:
 - A. 16-14 AWG [1,5-2,5 mm²] SOLID OR STRANDED COPPER WIRE
 - B. 221°F [105°C] MAX. OPERATING TEMPERATURE
 - C. 600V. MAX. BLDG WIRE (1000 V. MAX. IN SIGNS, FIXTURES & LUMINAIRES)
- MATERIAL:
 - A. STAMPING: .03" [0,8] THK COPPER, TIN PLATED
 - B. HOUSING: VINYL, BLUE
- WIRE STRIP LENGTH: 5/16" ^{+1/32}₋₀ [7,9mm ^{+0,8}₋₀]
- SEE www.panduit.com FOR PACKAGE QUANTITIES
- DIMENSIONS IN BRACKETS ARE METRIC EQUIVALENT

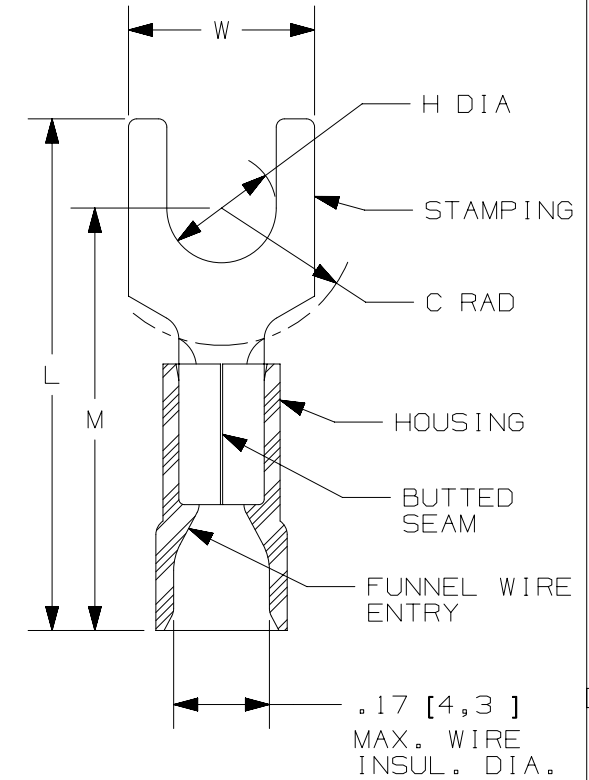

TITLE		STRONGHOLD FORK TERMINALS VINYL INSULATED, BUTTED SEAM #16-14 AWG		
ITEM REVISION NAME		CUSTOMER DRAWING		
00123SH0/00		PANDUIT TM		
DATASET FILE NAME				
UNLESS OTHERWISE SPECIFIED, DIMENSIONAL TOLERANCES ARE: IN [mm]		MATERIAL: SEE NOTES		
.X ± .XX ±		.XXX ± ANGLES ±		
THIRD ANGLE PROJECTION		DRAWING NUMBER: SH41193		
DRAWN BY	DATE	CHK	SCALE	SIZE
JHNU	2/18	TMR	N.T.S.	A
REV		DATE		BY
00		2/18		JHNU
DESCRIPTION		APR		RELEASED
ECN		00123SH		

D10100DA/12