

## SPECIFICATION & FEATURES

## NEMA TYPE 1 SCREW COVER ENCLOSURES WITHOUT K.O.

### DESCRIPTION:

Orbit Industries' NEMA Type 1 Enclosures with screw cover are suited for a variety of electrical applications and protect against dust, light, and indirect splashing. This heavy duty box is made with 16 Gauge, 14 Gauge, and 12 Gauge Steel with wall mounting holes on the back. Boxes are finished with ANSI 61 gray polyester powder paint and meet UL standards.



### CERTIFICATION:

UL file E331152,  
conforms to UL 50 and UL 50E



### FEATURES:

- ANSI 61 Gray Polyester Powder Paint Finish inside and out
- 16, 14, 12, Gauge Steel or Plated Steel
- Mounting holes on back of box
- Without Knock out

### KNOCK OUT PATTERNS:

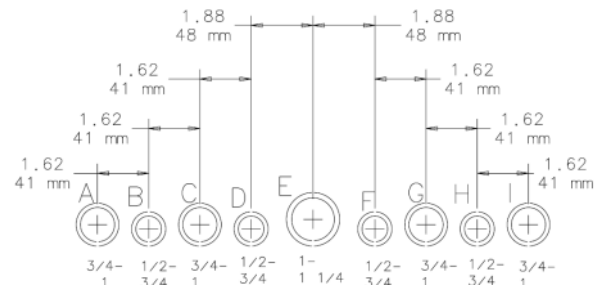

### CONFIGURATION DATA:

Part No.	Body Style	Enclosure Size (in)			Std.Pkg.
		Width (in)	Height (in)	Depth (in)	
444NK	A	4	4	4	6
464NK	A	4	6	4	6
664NK	A	6	6	4	6
666NK	A	6	6	6	6
884NK	A	8	8	4	6
886NK	A	8	8	6	4
10104NK	A	10	10	4	4
10106NK	A	10	10	6	4
12124NK	A	12	12	4	2
12126NK	A	12	12	6	2
12128NK	A	12	12	8	1
12186NK	A	12	18	6	1
16164NK	B	16	16	4	1
16166NK	B	16	16	6	1
16168NK	B	16	16	8	1
18184NK	B	18	18	4	1
18186NK	B	18	18	6	1
18188NK	B	18	18	8	1
24244NK	B	24	24	4	1
24246NK	B	24	24	6	1
24248NK	C	24	24	8	1

