

# Cable and Flexible Cord Connectors

## For Non-Metallic Sheathed Cable

### Type C-11LS

### Type 806 & Type 906

### 2-Screw Connector

### For round cable-open throat type

#### Use:

- Type C-11LS - to secure Non-Metallic Sheathed Cable to boxes and enclosures.
- Type 806 and Type 906 Series - to secure Non-Metallic Sheathed Cable, Service Entrance Cable and Flexible Cords to boxes and enclosures.

#### Features:

- Available with insulated throats
- Furnished with locknuts.
- Male hub threads NPS.

#### Material/Finish:

Malleable Iron/Zinc Electroplated

#### Third Party Certification:



UL Listed: E-11856  
 UL Listed for 806, 906Z, 908, 909  
 for NM and SE Cables  
 UL Listed: E-11858  
 UL Listed for 806, 906Z for SE Cable  
 C-11LS - UL Listed for NM Cable.



Certified File No. 11584 NM Cable

#### Applicable Third Party Standards:

UL Standard: 514B  
 CSA Standard C22.2 No. 18  
 Fed. Spec: W-F-406E  
 NEMA: FB-1

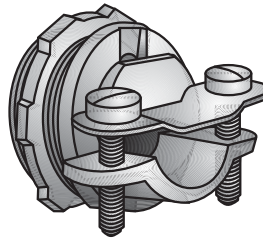

Type C-11LS

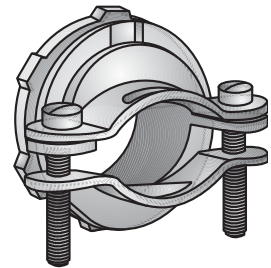

Type 806 — Type 908

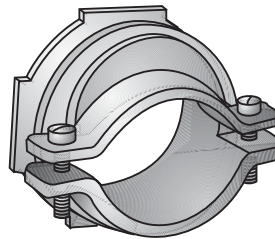

Type 909

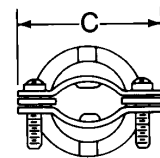
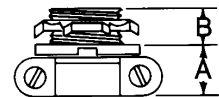

Trade Size (inches)	Catalog Number	Insulated Throat Catalog Number	Clamp Opening			Dimensions in Inches		
			Min.	Max.	Width	A	B	C
1/2	*C-11LS	*C-11LST	.19	.63	--	9/16	7/16	1 3/8
3/4	806	806T	.37	.84	.84	1 1/16	7/16	1 13/16
1	906Z	906T	.42	1.05	1.05	1 1/16	9/16	2 1/16
1 1/4	907	907T	.75	1.34	1.34	1 3/16	9/16	2 7/16
1 1/2	908	908T	.91	1.45	1.55	7/8	5/8	2 3/4
2	909	909T	1.39	2.03	2.03	1 5/16	3/4	3 3/8

\*Longer screw to accommodate extra flexible cables. Not CSA Certified.