

AIR TERMINAL BASE, IMPERIAL THREAD, COPPER, TINNED, 1/2 UNC THREAD, HORIZONTAL OR VERTICAL

CATALOG NUMBER

LPC305L12

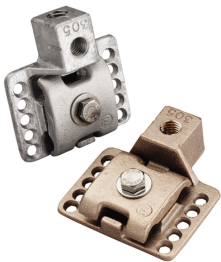

CERTIFICATIONS



FEATURES

Install with adhesive or screw down fixings

Mechanical connection recommended for vertical installation

Positive single bolt tension for multi-directional cable clamping

PRODUCT ATTRIBUTES

Conductor Size, UL: Class 1 - Class 2 (4/0 Max)

Material: Copper

Finish: Tinned

Thread Size: 1/2" UNC

Mounting: Horizontal or Vertical

Hole Size: 1/4"

Depth: 2.900"

Height: 1"

Width: 3.070"

Unit Weight: 0.835 lb

DIAGRAMS

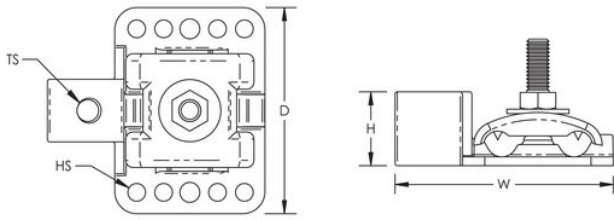

WARNING

nVent products shall be installed and used only as indicated in nVent's product instruction sheets and training materials. Instruction sheets are available at www.nvent.com and from your nVent customer service representative. Improper installation, misuse, misapplication or other failure to completely follow nVent's instructions and warnings may cause product malfunction, property damage, serious bodily injury and death and/or void your warranty.

⚠ WARNING: This product can expose you to chemicals including lead, which is known to the State of California to cause cancer and birth defects or other reproductive harm. For more information go to www.P65Warnings.ca.gov.

North America

+1.800.753.9221

Option 1 – Customer Care

Option 2 – Technical Support

Europe

Netherlands:

+31 800-0200135

France:

+33 800 901 793

Europe

Germany:

800 1890272

Other Countries:

+31 13 5835404

APAC

Shanghai:

+ 86 21 2412 1618/19

Sydney:

+61 2 9751 8500



Our powerful portfolio of brands:

nVent.com CADDY ERICO HOFFMAN RAYCHEM SCHROFF TRACER

© 2022 nVent. All nVent marks and logos are owned or licensed by nVent Services GmbH or its affiliates. All other trademarks are the property of their respective owners.

nVent reserves the right to change specifications without notice.