



FF
Female/Female



MF
Male/Female



GUFS



MM
Male/Male



BL
Male/Female



Y



EYMF

Class I, Div. 1 & 2, Groups C,D
Class II, Div. 1 & 2, Groups E,F,G
Class III



Listed - File E10514



Certified - File LR11716



File 25215



See files for details or call Killark.

FEATURES-SPECIFICATIONS

Applications

- Elbows: To change direction in rigid or IMC conduit systems
- Capped Elbows: To change direction 90° in rigid or IMC conduit systems where space is limited and access is needed for pulling conductors or maintenance
- Swivel Elbows: Allows conduit to be joined at angles ranging between 90° to 180°. A screwdriver is the only tool needed
- 90° Plugged Elbows: To change direction 90° in rigid or IMC conduit systems where space is limited and access is needed for pulling conductors or maintenance

Features

- Threaded for rigid conduit or IMC
- Smooth integral bushings to prevent damage to wires

Material/Finish

Copper-free Aluminum

(less than 4/10 of 1%)

- Electrostatically applied powder coating

Iron Zinc electro-plate

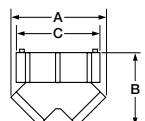
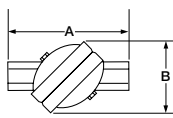
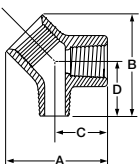
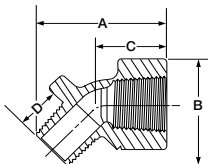
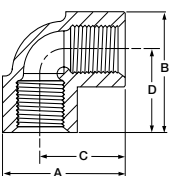

KILLARK®

ELBOWS							
CATALOG NUMBER		HUB SIZE	TYPE	A	B	C	D
ALUMINUM	IRON						
FF-90-1 ^①	FF-90-1M ^③	1/2"	FF	2"	2"	1-3/8"	1-3/8"
FF-90-2 ^①	FF-90-2M ^③	3/4"	90°	2-1/4"	2-1/4"	1-1/2"	1-1/2"
FF-90-3 ^①	FF-90-3M ^③	1"		2-15/16"	2-15/16"	2"	2"
FF-45-1 ^①	FF-45-1M ^③	1/2"		2-3/8"	2"	1-1/8"	—
FF-45-2 ^①	FF-45-2M ^③	3/4"	FF	2-11/16"	2-3/16"	1-1/4"	—
FF-45-3 ^①	FF-45-3M ^③	1"	45°	3-3/8"	2-11/16"	1-5/8"	—
FF-45-6 ^①	FF-45-6M ^③	2"		4-3/4"	3-7/8"	2-1/4"	—
MF-90-1 ^①	MF-90-1M ^③	1/2"	MF	11/16"	2"	1-3/8"	1-3/8"
MF-90-2 ^①	MF-90-2M ^③	3/4"	90°	7/8"	2-7/16"	1-1/2"	1-11/16"
MF-45-1 ^①	MF-45-1M ^③	1/2"	MF	2-1/8"	1-3/4"	1-1/8"	3/4"
MF-45-2 ^①	MF-45-2M ^③	3/4"	45°	2-3/8"	1-7/8"	1-9/32"	3/4"
MM-90-1 ^①	MM-90-1M ^③	1/2"	MM	2-1/16"	2-1/16"	1-3/8"	1-3/8"
MM-90-2 ^①	MM-90-2M ^③	3/4"	90°	2-1/4"	2-1/4"	1-1/2"	1-1/2"
BL-90-1 ^①	BL-90-1M ^③	1/2"	BL	2-1/4"	2-3/8"	1-7/8"	1-3/4"
BL-90-2 ^①	BL-90-2M ^③	3/4"	90°	2-5/8"	3"	2-1/8"	2-1/4"
BL-90-3 ^①	BL-90-3M ^③	1"		2-1/4"	3-7/16"	2-5/8"	2-1/2"

CAPPED ELBOWS							
CATALOG NUMBER		HUB SIZE	TYPE	A	B	C	D
ALUMINUM	IRON						
Y-1 ^①	Y-1M ^④	1/2"	90°	2-7/8"	2-3/4"	1-7/8"	—
Y-2 ^①	Y-2M ^④	3/4"	90°	3-1/16"	3-3/4"	2-1/8"	—
Y-3 ^①	Y-3M ^④	1"	90°	4"	3-1/4"	2-5/8"	—
Y-4 ^①	Y-4M ^④	1-1/4"	90°	5-1/16"	4-1/8"	3-7/8"	—
Y-5 ^①	Y-5M ^④	1-1/2"	90°	5-1/16"	4-1/4"	3-7/8"	—

SWIVEL ELBOWS							
CATALOG NUMBER		HUB SIZE	TYPE	A	B	C	D
ALUMINUM	IRON						
GUFS-1 ^②	GUFS-1M ^③	1/2"	180°	4-1/2"	2-1/4"	—	—
GUFS-2 ^②	GUFS-2M ^③	3/4"	180°	4-1/2"	2-1/4"	—	—
GUMFS-1 ^②	GUMFS-1M ^③	1/2"	180°	5-1/8"	2-1/4"	—	—
GUMFS-2 ^②	GUMFS-2M ^③	3/4"	180°	5-1/4"	2-1/4"	—	—

90° PLUGGED ELBOWS							
CATALOG NUMBER ^⑤		HUB SIZE	TYPE	A	B	C	D
ALUMINUM	IRON						
EYMF-1 ^②	—	1/2"	90°	2-5/8"	2-5/8"	1-3/8"	1-3/8"
EYMF-2 ^②	—	3/4"	90°	2-3/4"	2-3/4"	1-1/2"	1-1/2"

^① Copper-free aluminum - Electrostatically applied powder coating

^② Aluminum - Natural finish

^③ Iron - Zinc electroplate

^④ Iron - Duraloy finish

^⑤ Furnished with 1" close-up plug in top.