

Thermal Overload Relays – NEMA Rated Melting Alloy

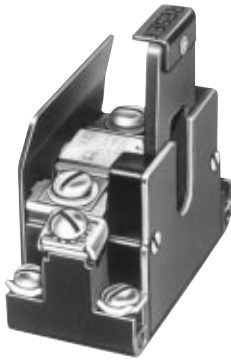

Type CO1R

NEMA-rated Thermal Overload Relays feature:

- Exclusive One-Piece Thermal Unit
- Inverse Time Delay Trip
- Alarm Contact Available
- Trip Free Reset Mechanism on Types F, G & S
- Replaceable Contact Units on Types F, G & S

Slow trip (Class 30) and quick trip (Class 10) melting alloy thermal units are available for all Size 1, 2, 5 and 6, and some Size 3 and 4 applications. Thermal units are not included.

For Separate Mounting – Melting Alloy – 600 Volts Maximum, AC or DC*

Size	Maximum Full Load Current (Amperes)	Open Type for Separate Panel Mounting		For Terminal Block Channel Mounting Order
		Left Hand Type	Right Hand Type	Type
Single Pole Construction (One N.C. Contact) — 1 Thermal Unit Required				
1	25	CO1	CO1R	...
2	45	TO1	TO1	...
3	86	UO1	UO1	...
4	133	FO1L	FO1R	...
5	266	GO11L	GO11R	...

Three Pole Construction (One Common N.C. Contact on Type S Only) — 3 Thermal Units Required

1	25	SEO5	SM2
2	45	SEO8	SM2
3	86	SEO12	...
4	133	SEO15	...
5	266	Use 3 Type GO11R Relays Listed Above	

* Maximum power circuit rating for separate mounting overload relays, Types C, F, G, T and U, is 600 volts AC or DC; Type S is 600 volts AC only. Maximum control circuit contact rating for Types C, F, G, T, U and SDO18 is 600 volts AC and 250 volts DC; the remaining Type S versions are 600 volts AC only.



Type SEO5

Replacement Melting Alloy Overload Relays for Square D Class 8536 Starters

Locate Class 8536 Starter in this Column				Order Class 9065 Overload Relay from this Column	
NEMA Size	Type	Series	Number of Poles	Type	Number of Thermal Units Required
00	SA	A & B	2 3	SDO4 SDO5	1 3
0	SB	A	2 3-5	SDO4 SDO5	1 3▲
1	SC	A	2 3-5	SDO4 SDO5	1 3▲
1P	SC	A	2	SDO10	1
2	SD	A	2 3-5	SDO7 SDO8	1 3▲
3	SE	A	2	SDO11	1
			3	SDO12	3
			4	SDO13	2
			5	SDO14	3
4	SF	A	3	SDO15	3
			4	SDO16	2
			5	SDO17	3
5	SG	A	3‡	SDO18	1
6	SH	A & B	3	SEO5	3

▲ For 4-pole starters used on two phase systems order 2 thermal units plus one Class 9998 Type SO31 jumper strap kit for every two starters. Each kit includes two jumper straps.

‡ Type S Size 5 starters use three Type SDO18 overload relays per starter.

Special Features for Melting Alloy Types

	Form
Substitute 1-N.O. isolated alarm contact and 1-N.C. contact per relay. (Type S starters only)▼	Y342▼
Substitute 2-N.C. contacts for standard N.C. contact per relay. (Type S starters only)	Y344▼
Modify Type U relay to accept Type FB quick trip or SB slow trip thermal units. (Accepts Type C standard trip)	Y21●
Modify Type SDO12 relays to accept Type FB quick trip or SB slow trip thermal units, and Type F, and Type SDO15 relays to accept Type FB quick trip thermal units. (Rejects Type CC standard trip units)	Y81●

● This form cannot be field modified.

▼ Field modification possible. Order 9999 S04 (for Form Y342) or 9999 S05 (for Form Y344).

