

For use with all channel series to complete enclosure.

G-969A Closure Strip for New Style Kindorf Channel



Cat. No.	Description
G-969A	Steel Closure Strip—Galv-Krôm finish
G-969AP	Plastic Closure Strip—Gold

19 ga. steel, 35#/C. U.L. Listed for raceway.

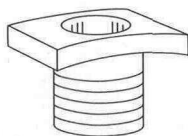
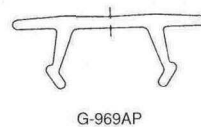
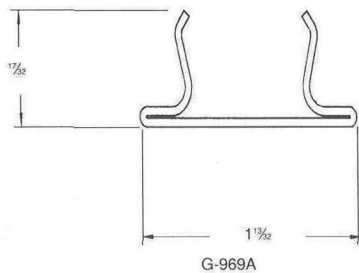

The 1/2" size can nipple fixtures through channel knockouts. All sizes can be fastened to the open slot of all Kindorf channels. Locknut supplied with nipple.

G-972 Nipple Malleable Iron

Cat. No.	A	B	C	Wt. in lbs./C
G-972-1/2	1/2" Pipe Size	7/8"	1 1/4"	7
G-972-3/4	3/4" Pipe Size	7/8"	1 1/4"	11
G-972-L-1/2	1/2" Pipe Size	2"	1 1/4"	9

The extra length of the G-972-L-1/2 permits its use as a spacing nipple when locked into knockout or continuous slot.

Load rating 750#, with a safety factor of 3.

Galv-Krôm finish

